

1947-8



V0019470050011

MONTAGEANLEITUNG

ASSEMBLY INSTRUCTIONS

NOTICE DE MONTAGE

MONTAGEHANDLEIDING

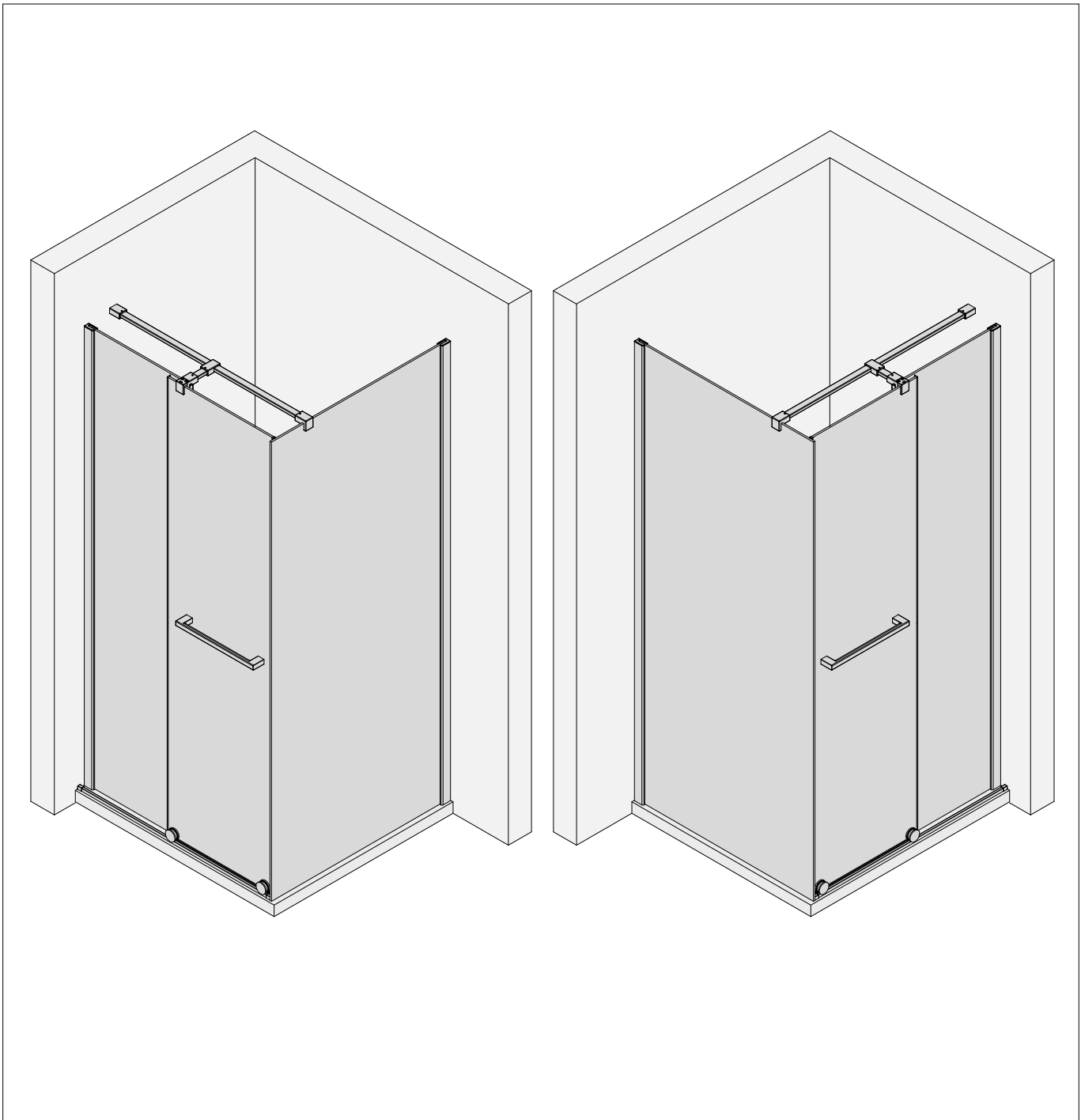



SICHERHEITSHINWEISE / SAFETY INSTRUCTIONS CONSEILS DE SÉCURITÉ / VEILIGHEIDSAANWIJZINGEN



de Glaskanten schützen

en Protect glass edges

fr Protégez les bords du verre

nl Glasranden beschermen



de Schutzbrille tragen

en Wear safety goggles

fr Portez des lunettes de protection

nl Veiligheidsbril dragen

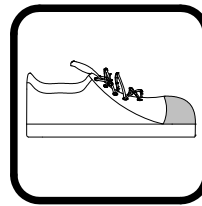

de Sicherheitsschuhe tragen

en Wear safety shoes

fr Portez des chaussures de sécurité

nl Veiligheidsschoenen dragen

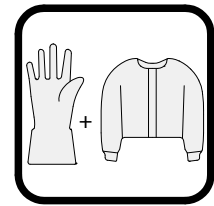

de Lange Handschuhe und langärmelige Kleidung tragen

en Wear long gloves and long-sleeved clothing

fr Portez des gants longs et des vêtements à manches longues

nl Draag lange handschoenen en kleding met lange mouwen

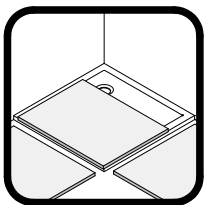

de Decken im Arbeitsbereich und dessen Umfeld auslegen

en Cover the shower tray and its area completely

fr Couvrez complètement le bac de douche et ses environs

nl Dekens op de douchebak en de omgeving leggen

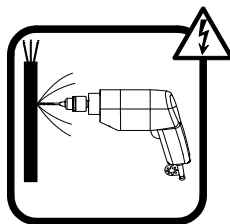

de Über die Lage der Stromleitung informieren

en Get information about the location of the power line

fr Informez-vous sur l'emplacement de la ligne électrique

nl Informeren over de locatie van de hoogspanningslijn

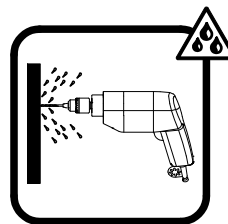

de Über die Lage der Wasserleitung informieren

en Get information about the location of the water pipe

fr Informez-vous sur l'emplacement de la ligne d'eau

nl Informeren over de locatie van de waterleiding

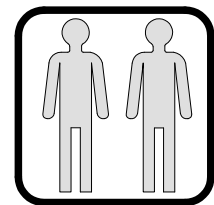

de Empfohlene Montage mit 2 Personen.

en Assembly recommended with 2 persons

fr Montage recommandé avec 2 personnes

nl Aanbevolen montage met 2 personen

HINWEIS / NOTE / NOTE / NOOT

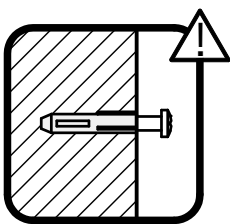

de Vor der Montage die Beschaffenheit des Mauerwerks überprüfen. Gegebenenfalls ist das im Lieferumfang enthaltene Befestigungsmaterial nicht für die Befestigung geeignet.

en Check the condition of the masonry before installation. If applicable, the fixing material included in the scope of delivery is not suitable for mounting.

fr Vérifiez l'état de la maçonnerie avant le montage. Le cas échéant, le matériel d'approvisionnement compris dans la livraison n'est pas adapté à la fixation.

nl Controleer de toestand van het metselwerk voor de installatie. Indien gewenst is het bij de levering inbegrepen bevestigingsmateriaal niet geschikt voor montage.

de Die Aufstellfläche der Duschkabine muss eben sein.

en The installation surface of the shower enclosure must be level.

fr La surface d'installation de la cabine de douche doit être plane.

nl Het montagevlak van de douchewand moet waterpas zijn.

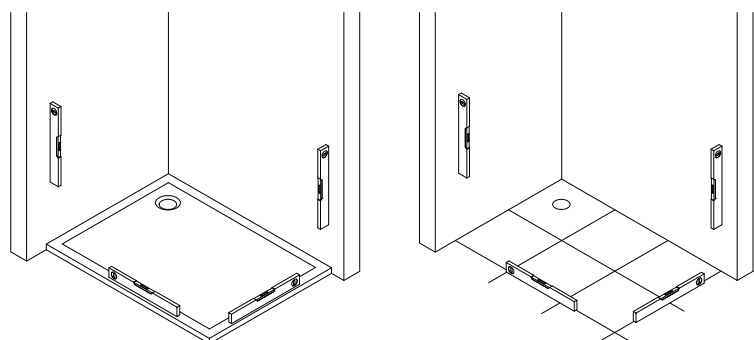

AUFBAUART / ASSEMBLY SITUATION / TYPE DE MONTAGE / ASSEMBLAGE SITUATIE

de Bei der Montage der Duschkabine gibt es zwei Aufbauarten: Aufbau **a** und **b**
In dieser Montageanleitung wird der Aufbau **a** dargestellt. Die Montageschritte für den Aufbau **b** sind
spiegelbildlich durchzuführen.

en There are two types of installation for the shower enclosure: **a** and **b**
Situation **a** is described in this assembly instruction. The assembly steps for situation **b** must be carried out
in mirror image.

fr Il y a 2 possibilités de monter la paroi de douche : **a** et **b**
La version **a** est illustrée dans la notice de montage. Les étapes pour monter la version **b** sont inversées.

nl Er zijn twee soorten installatie voor de douchewand: **a** en **b**
Montage **a** wordt getoond in deze montagehandleiding. De montageschappen voor installatie **b** moeten in
spiegelbeeld worden uitgevoerd.

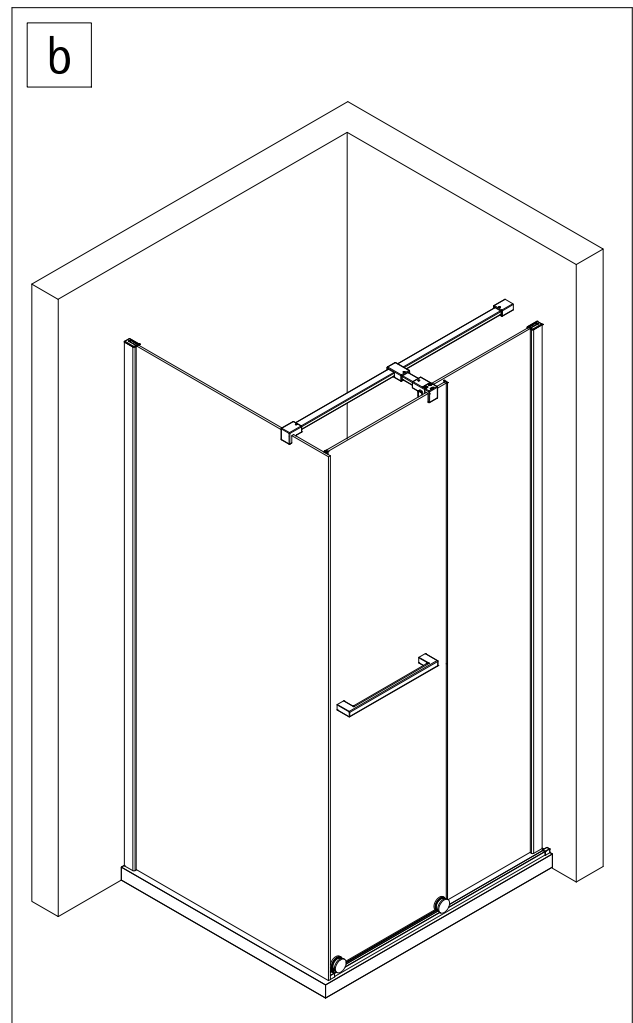
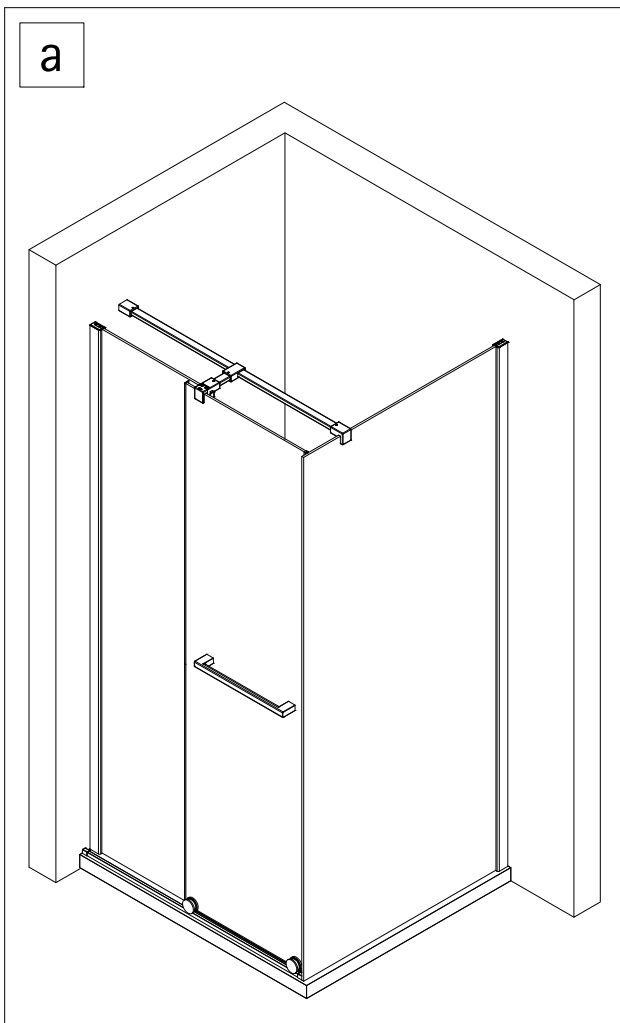

MABE / DIMENSIONS / DIMENSIONS / AFMETINGEN

- de** Prüfen, ob die gemessenen Maße innerhalb der Tabellenwerte (A, B bzw. C, D) liegen, damit die Duschkabine problemlos, anhand der Montageanleitung aufgebaut werden kann.
- en** Check whether the measured dimensions are within the table values (A, B or C, D), so that the shower enclosure can be assembled without any problems using the assembly instructions.
- fr** Vérifier que les dimensions mesurées se situent dans les valeurs du tableau (A, B ou C, D), afin que la cabine de douche puisse être montée sans problèmes en suivant les instructions de montage.
- nl** Controleer of de gemeten afmetingen binnen de tabelwaarden (A, B of C, D) vallen, zodat de douchewand zonder problemen met behulp van de montagehandleiding kan worden gemonteerd.

de Montage auf Duschwanne

(Maße des installierten Duschbeckens)

en Mounting on shower tray

(Dimensions of the installed tray)

fr Montage sur receveur de douche

(Dimensions du mur au bord d'extérieur du receveur)

nl Montage op douchebak

(Afmetingen van de ingebouwde douchebak)

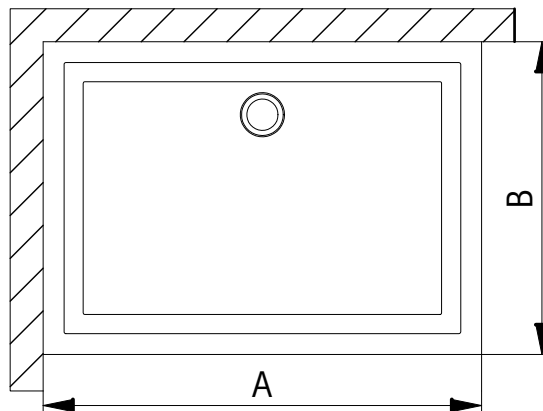

Duschwanne / shower tray receveur de douche / douchebak	A (Türseite / door side / côté porte / deur zijde)	B (Seitenwandseite / side of side panel / côté paroi / zijwand zijde)
800 mm		785 - 805 mm
900 mm		885 - 905 mm
1000 mm	985 - 1005 mm	985 - 1005 mm
1200 mm	1185 - 1205 mm	
1400 mm	1385 - 1405 mm	

oder / or / ou / of

de Montage ohne Duschwanne

(Abmessungen des Produktes) (Glasmitte)

en Mounting without shower tray

(Mounting on tile) (Middle of the glass)

fr Montage sans receveur de douche

(Montage sur carrelage) (Dimension mi-verre)

nl Montage zonder douchebak

(Montage op tegel) (midden van het glas)

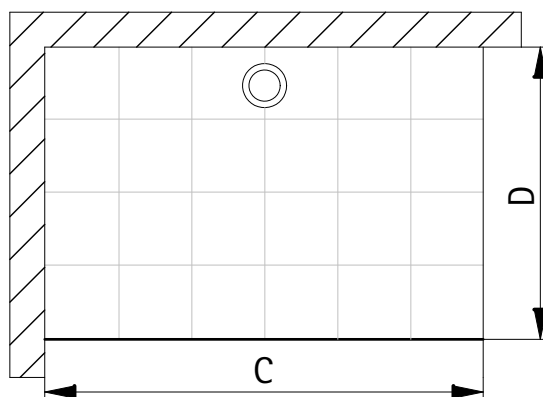

Version / Versie	C (Tür / door / porte / deur)	D (Seitenwand / side panel / paroi latérale / zijwand)
800 mm		728 - 748 mm
900 mm		828 - 848 mm
1000 mm	958 - 978 mm	928 - 948 mm
1200 mm	1158 - 1178 mm	
1400 mm	1358 - 1378 mm	

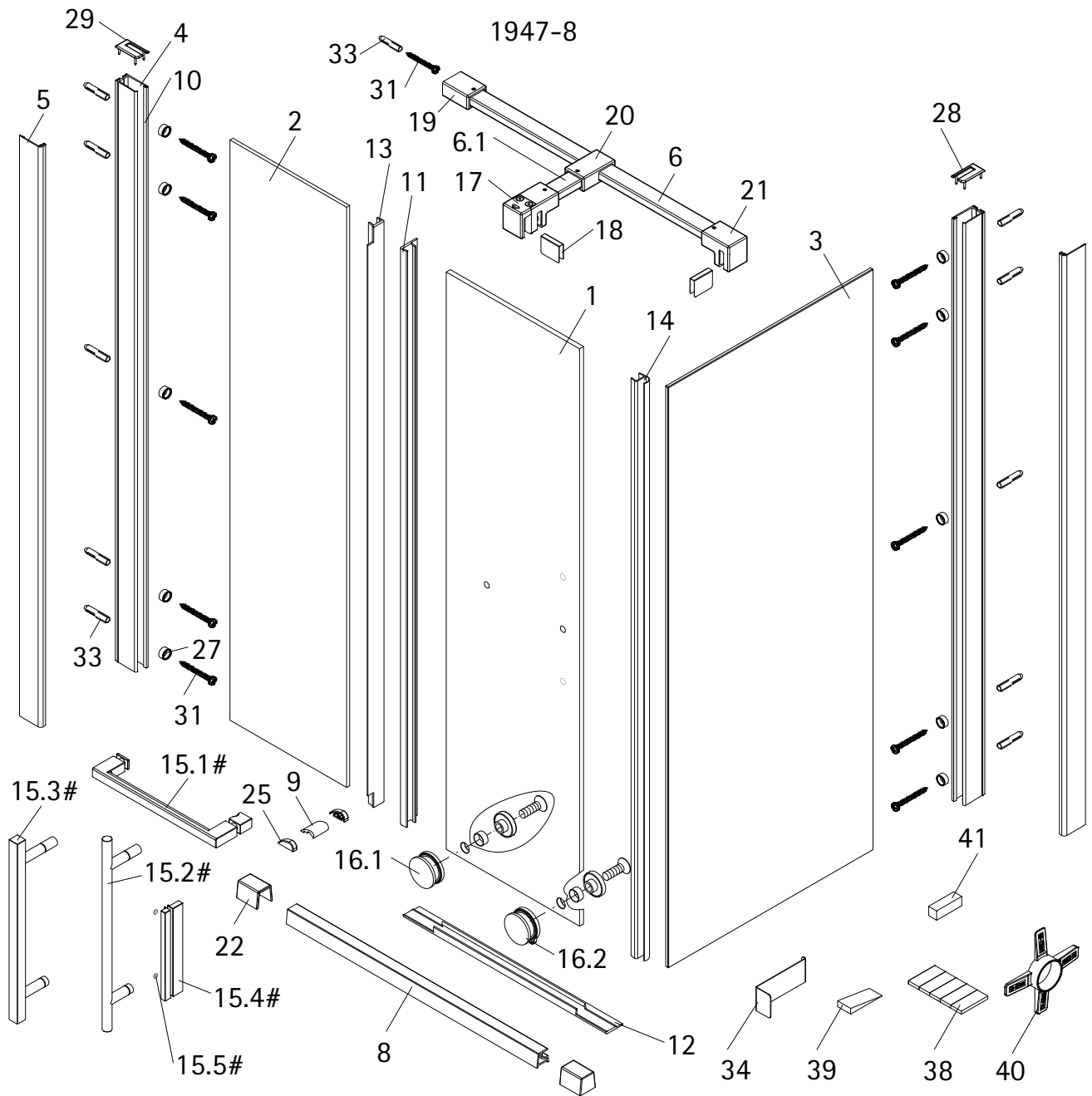

Pos.	Bezeichnung	Ersatzteil-Nr.
1	1x Türscheibe	
2	1x Nebenteilscheibe	
3	1x Seitenwandscheibe	
4	2x Wandanschlussprofil (inkl. Pos. 10)	E100248-44-3 Stück
5	2x Clipsprofil	E100249-44-1-8-3 Stück
6	1x Stabilisationsbügel (inkl. Pos. 18, 19, 21)	E33338-1 Set
6.1	1x Kreuzverstrebung (inkl. Pos. 17, 18, 20)	E33338-3 Set
8	1x Laufschiene (inkl. Pos. 22)	E33301-1 Stück
9*	1x Wasserleiste (inkl. Pos. 38)	
10	2x Dichtprofil	
11	1x Dichtung vertikal	E100057-4 Stück
12	1x Dichtung	E100057-4 Stück
13	1x Dichtung vertikal	E100057-4 Stück
14	1x Streifdichtung, offen	E100077-8 Stück
15.1#	1x Stangengriff, eckig	E100140-36 Stück
15.2#	1x Stangengriff, rund	E100140-26 Stück
15.3#	1x Stangengriff, eckig	E100140-29 Stück
15.4#	1x Riegelgriff, eckig (inkl. Pos. 15.5)	E100140-16 Stück
15.5#	2x Klebepuffer für Riegelgriff	
16.1	1x Laufrolle mit Puffer, komplett	E33262-1 Stück
16.2	1x Laufrolle mit Sicherung, komplett	E33262 Stück

Pos.	Bezeichnung	Ersatzteil-Nr.
17	1x Gleiter	E33280 Stück
18	2x Glasschutz Gleiter	
19	1x Wandhalter	E100344 Stück
20	1x T-Verbinder	E33322 Stück
21	1x Glashalter	E33280-1 Stück
22	2x Kappe für Laufschiene	E100211-26 Set
25	2x Wasserleistenendkappe	E100211-17 Set
27*	10x Glasschutz	
28	1x Kappe rechts	} E71205-2 Set
29	1x Kappe links	
31*	11x Schraube 4,2 x 45mm	
33*	11x Dübel Ø 6 mm	
34*	1x Demontagehebel	E100201-1 Stück
38	4x Klebestreifen	
39	1x Silikonkeil (6 Stück)	E100203 Set
40	2x Montagekeil	E100201-2 Set
41	1x Montagehilfe 8 x 8 x 25mm	E100201-4 Set
	* Montagezubehör	E33200-2
	# optional	

de Geben Sie bei farbigen Ersatzteilen den Farbcode mit an: 01 - aluminium | 41 - chrom | 68 - schwarz
en Please state the colour code for coloured spare parts: 01 - aluminium | 41 - chrome | 68 - black
fr Veuillez indiquer le code couleur pour les pièces de rechange colorées : 01 - aluminium | 41 - chromé | 68 - noir
nl Gelieve de kleurcode voor gekleurde onderdelen te vermelden: 01 - aluminium | 41 - chroom | 68 - zwart

en

Pos.	Description		
1	1x door panel		
2	1x fixed panel		
3	1x side panel		
4	2x wall connection profile (incl. Pos. 10)	E100248-44-3	piece
5	2x clamping profile	E100249-44-1-8-3	piece
6	1x stabilizing bar (incl. Pos. 17, 18, 19)	E33338-1	Set
6.1	1x stabilizing bar	E33338-3	Set
8	1x slide rail profile (incl. Pos. 22, 38)	E33301-1	piece
9*	1x sealing profile		
10	2x sealing profile		
11	1x sealing profile vertical door	E100057-4	piece
12	1x sealing profile, short	E100057-4	piece
13	1x sealing profile vertical	E100057-4	piece
14	1x sealing profile	E100077-8	piece
15.1#	1x designer handle, square	E100140-36	piece
15.2#	1x designer handle, round	E100140-26	piece
15.3#	1x designer handle, square	E100140-29	piece
15.4#	1x designer handle, square (incl. Pos. 15.5)	E100140-16	piece
15.5#	2x buffer for handle		
16.1	1x roller, complete	E33262-1	piece
16.2	1x roller with safety device	E33262	piece

fr

Pos.	Description		
1	1x panneau de la porte		
2	1x partie fixe		
3	1x paroi latérale		
4	2x profilé mural de fixation (incl. Pos. 10)	E100248-44-3	Pièce
5	2x profilé de pincement	E100249-44-1-8-3	Pièce
6	1x barre de stabilisation (incl. Pos. 17, 18, 19)	E33338-1	Set
6.1	1x barre de stabilisation	E33338-3	Set
8	1x glissière profilé (incl. Pos. 22, 38)	E33301-1	Pièce
9*	1x barre de seuil		
10	2x profilé d'étanchéité		
11	1x profilé d'étanchéité vertical porte	E100057-4	Pièce
12	1x profilé d'étanchéité, court	E100057-4	Pièce
13	1x profilé d'étanchéité vertical	E100057-4	Pièce
14	1x profilé d'étanchéité	E100077-8	Pièce
15.1#	1x poignée barre, carré	E100140-36	Pièce
15.2#	1x poignée barre, rond	E100140-26	Pièce
15.3#	1x poignée barre, carré	E100140-29	Pièce
15.4#	1x poignée barre, carré (incl. Pos. 15.5)	E100140-16	Pièce
15.5#	2x butoir poignée barre		
16.1	1x roulette complete	E33262-1	Pièce
16.2	1x roulette avec dispositif de sécurité	E33262	Pièce

nl

Pos.	Omschrijving		
1	1x deurpaneel		
2	1x zijdeel		
3	1x zijwand		
4	2x wandaansluitprofiel (incl. Pos. 10)	E100248-44-3	stuk
5	2x klemprofiel	E100249-44-1-8-3	stuk
6	1x stabilisatie stang (incl. Pos. 17, 18, 19)	E33338-1	set
6.1	1x stabilisatie stang	E33338-3	set
8	1x looprail profiel (incl. Pos. 22, 38)	E33301-1	stuk
9*	1x dorpelprofiel		
10	2x afdichtingsprofiel		
11	1x afdichtingsprofiel verticaal deur	E100057-4	stuk
12	1x afdichtingsprofiel kort	E100057-4	stuk
13	1x afdichtingsprofiel verticaal	E100057-4	stuk
14	1x afdichtingsprofiel	E100077-8	stuk
15.1#	1x staafgreep, hoekig	E100140-36	stuk
15.2#	1x staafgreep, rond	E100140-26	stuk
15.3#	1x staafgreep, hoekig	E100140-29	stuk
15.4#	1x staafgreep, hoekig (incl. Pos. 15.1)	E100140-16	stuk
15.5#	2x buffer staafgreep		
16.1	1x spoorwals, compleet	E33262-1	stuk
16.2	1x spoorwals met beveiliging	E33262	stuk

Pos.	Description		
17	1x slider	E33280	piece
18	2x glass gasket slider		
19	1x wall holder	E100344	piece
20	1x T-connector	E33322	piece
21	1x glass buffer	E33280-1	piece
22	2x end cap	E100211-26	Set
25*	2x end cap for sealing profile	E100211-17	Set
27*	10x glass gasket		
28*	1x cover cap, right	} E71205-2	Set
29*	1x cover cap, left		
31*	11x screw 4,2 x 45mm		
33*	11x dowel Tri 6 x 36mm		
34*	1x disassembly lever	E100201-1	piece
38	4x adhesive stripes		
39*	1x assembly wedge	E100203	Set
40*	2x assembly aid	E100201-2	Set
41	1x assembly aid 8 x 8 x 25mm	E100201-4	Set
	* mounting equipment	E33200-2	
	# optional		

Pos.	Description		
17	1x coulissant	E33280	Pièce
18	2x protection du verre coulissant		
19	1x mur support	E100344	Pièce
20	1x connecteur en T	E33322	Pièce
21	1x patère de reception sur verre	E33280-1	Pièce
22	2x capuchon	E100211-26	Set
25*	2x capuchon pour profilé d'étanchéité	E100211-17	Set
27*	10x protection du verre		
28	1x cache droite	} E71205-2	Set
29*	1x cache gauche		
31*	11x vis 4,2 x 45mm		
33*	11x cheville Tri 6 x 36mm		
34*	1x levier de démontage	E100201-1	Pièce
38	4x ruban adhésif		
39*	1x cales de montage	E100203	Set
40*	2x kit de montage	E100201-2	Set
41	1x kit de montage 8 x 8 x 25mm	E100201-4	Set
	* accessoires de montage	E33200-2	
	# en option		

Pos.	Omschrijving		
17	1x glijder	E33280	stuk
18	2x pakkingstrip glijder		
19	1x wandhouder	E100344	stuk
20	1x T-stekker	E33322	stuk
21	1x glashouder	E33280-1	stuk
22	2x eindkap links/ rechts	E100211-26	set
25*	2x eindkap voor dorpelprofiel	E100211-17	set
27*	10x pakkingstrip		
28	1x afdekkap rechts	} E71205-2	set
29*	1x afdekkap links		
31*	11x schroef 4,2 x 45mm		
33*	11x plug Tri 6 x 36mm		
34*	1x demontage hendel	E100201-1	stuk
38	4x plakbanden		
39*	1x montage keggen	E100203	set
40*	2x montagehulp	E100201-2	set
41	1x montagehulp 8 x 8 x 25mm	E100201-4	set
	* montageonderdelen	E33200-2	
	# optioneel		

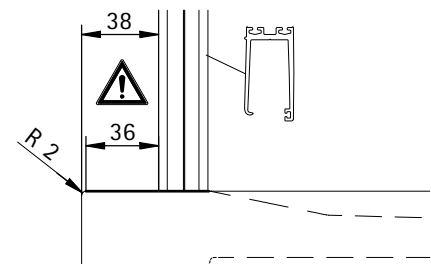
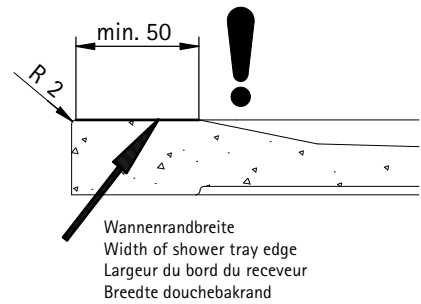
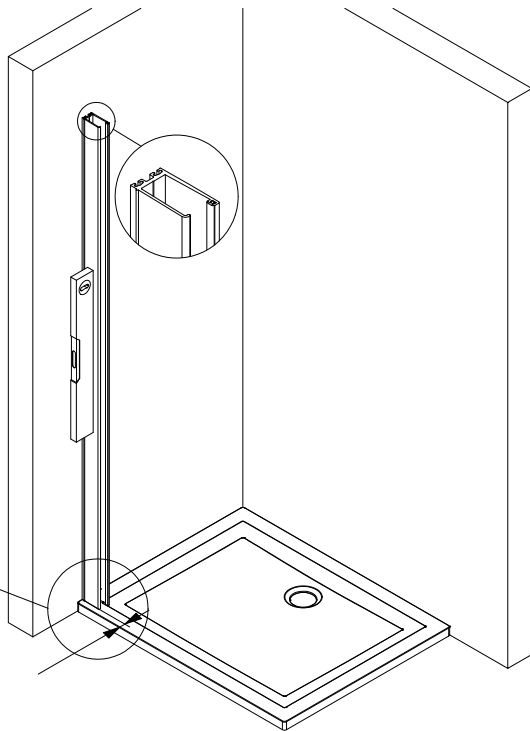
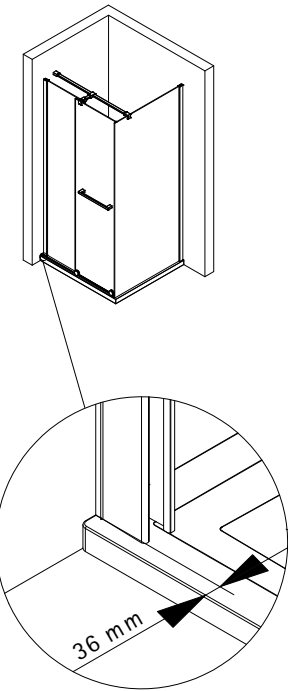
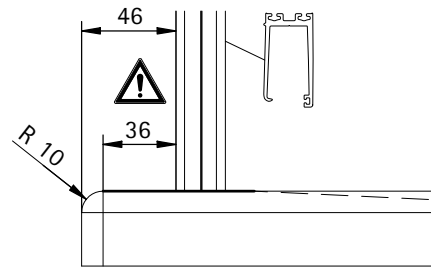
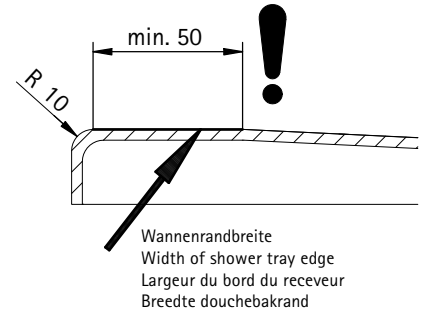
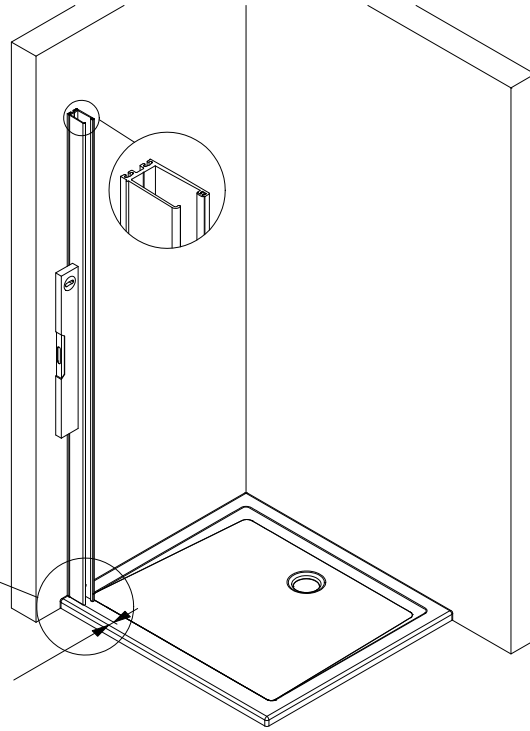
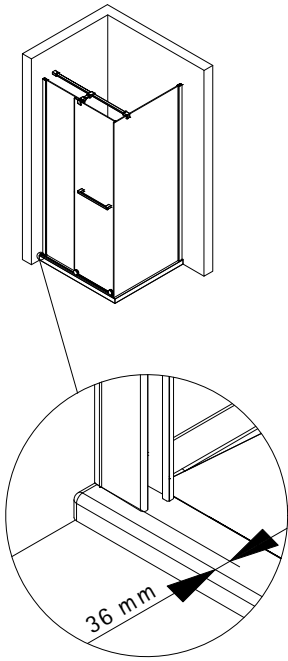

alle Maße in mm/ all dimensions in mm/ toutes les dimensions en mm/ alle afmetingen in mm

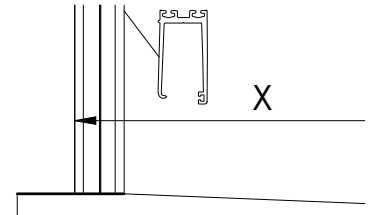
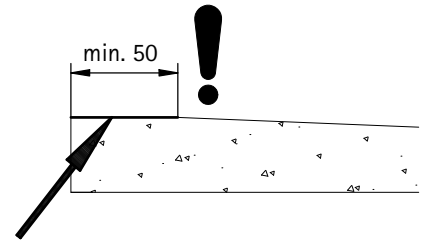
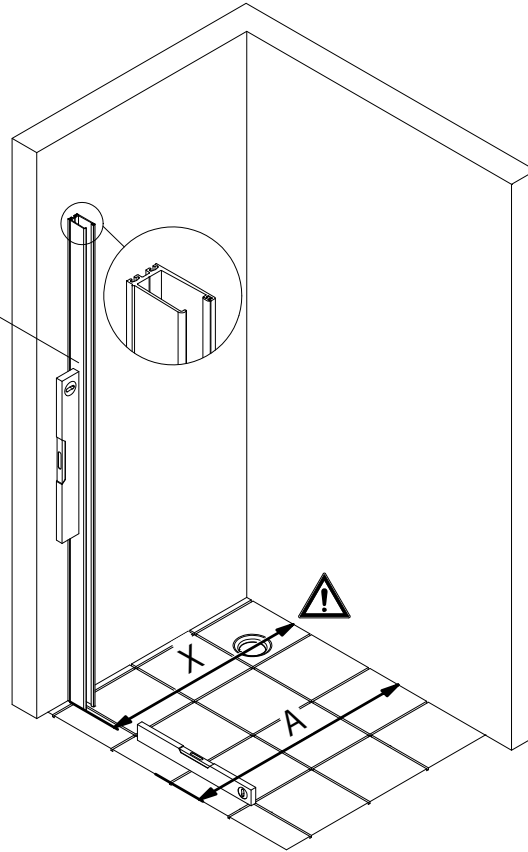
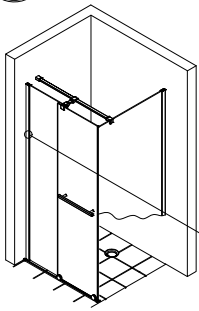

A	X
750 mm	704 mm
800 mm	754 mm
900 mm	854 mm
1000 mm	954 mm

alle Maße in mm/ all dimensions in mm/ toutes les dimensions en mm/ alle afmetingen in mm

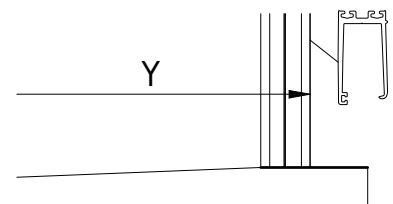
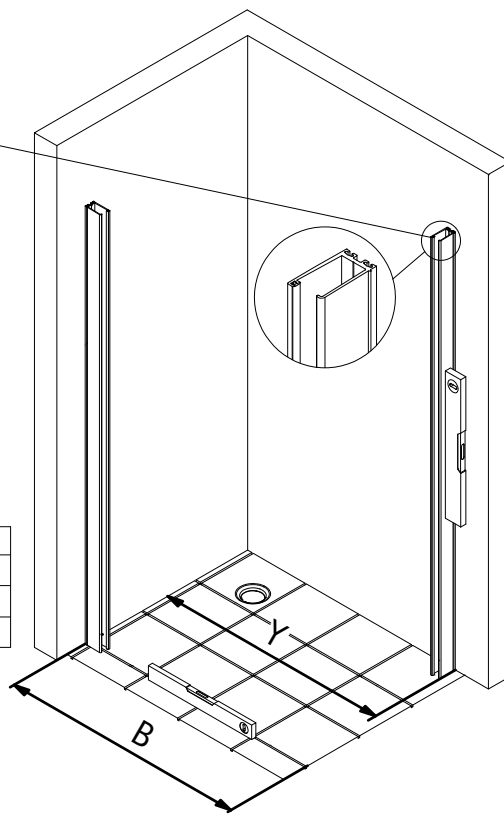
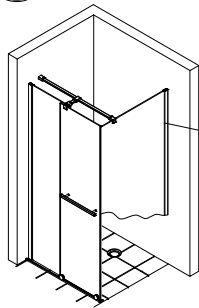

B	Y
1000 mm	986 mm
1200 mm	1186 mm
1400 mm	1386 mm
1600 mm	1586 mm

BENÖTIGTES WERKZEUG / TOOLS NEEDED
OUTILLAGE NÉCESSAIRE / BENODIGD WERKTUIG

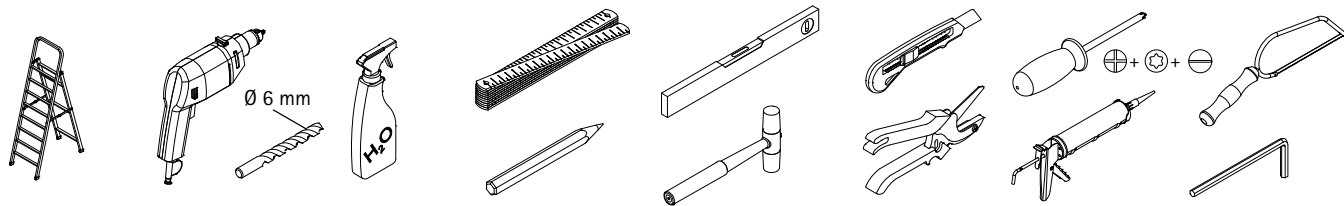

MONTAGE / ASSEMBLY / ASSEMBLAGE / ASSEMBLAGE

1

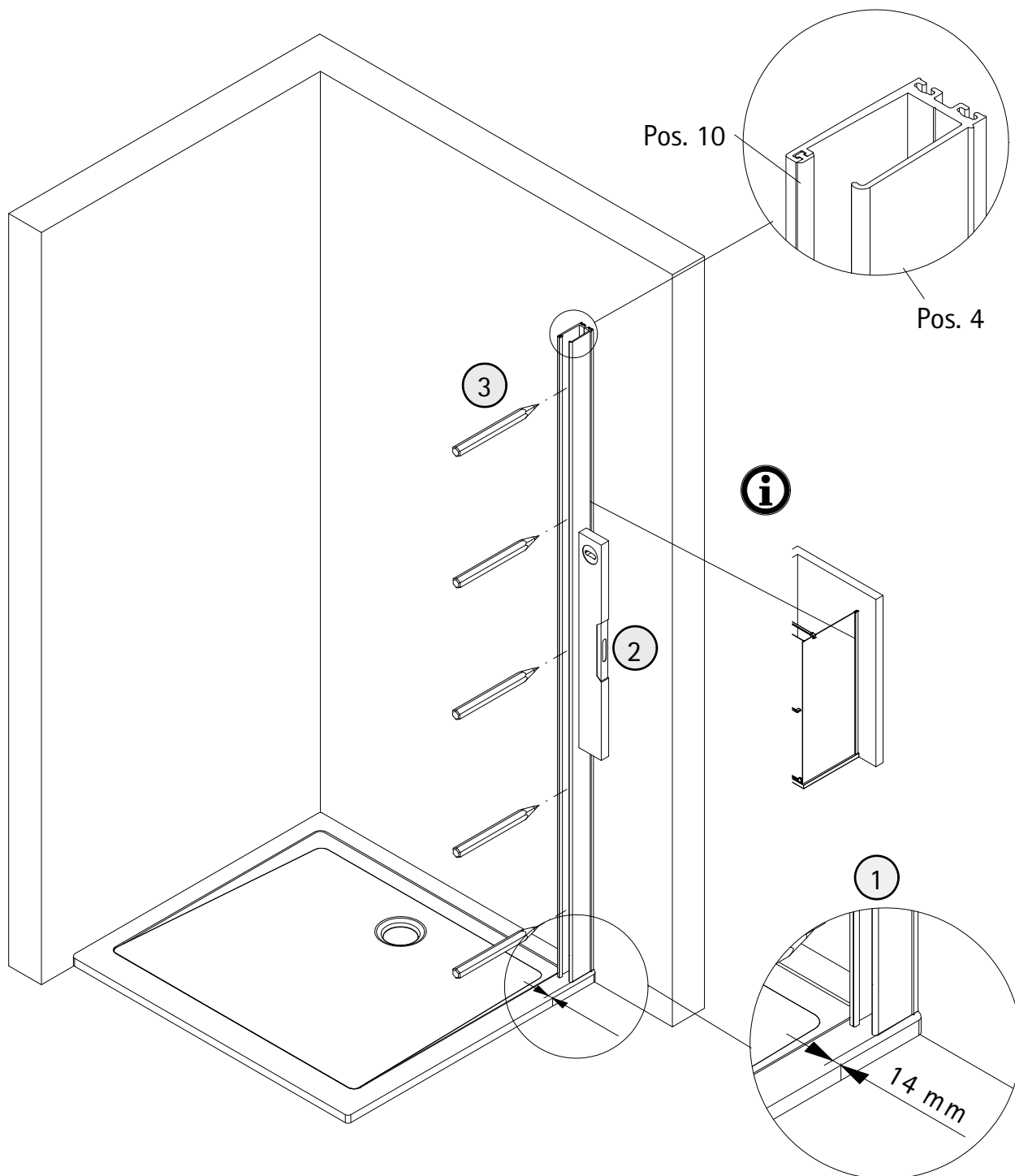

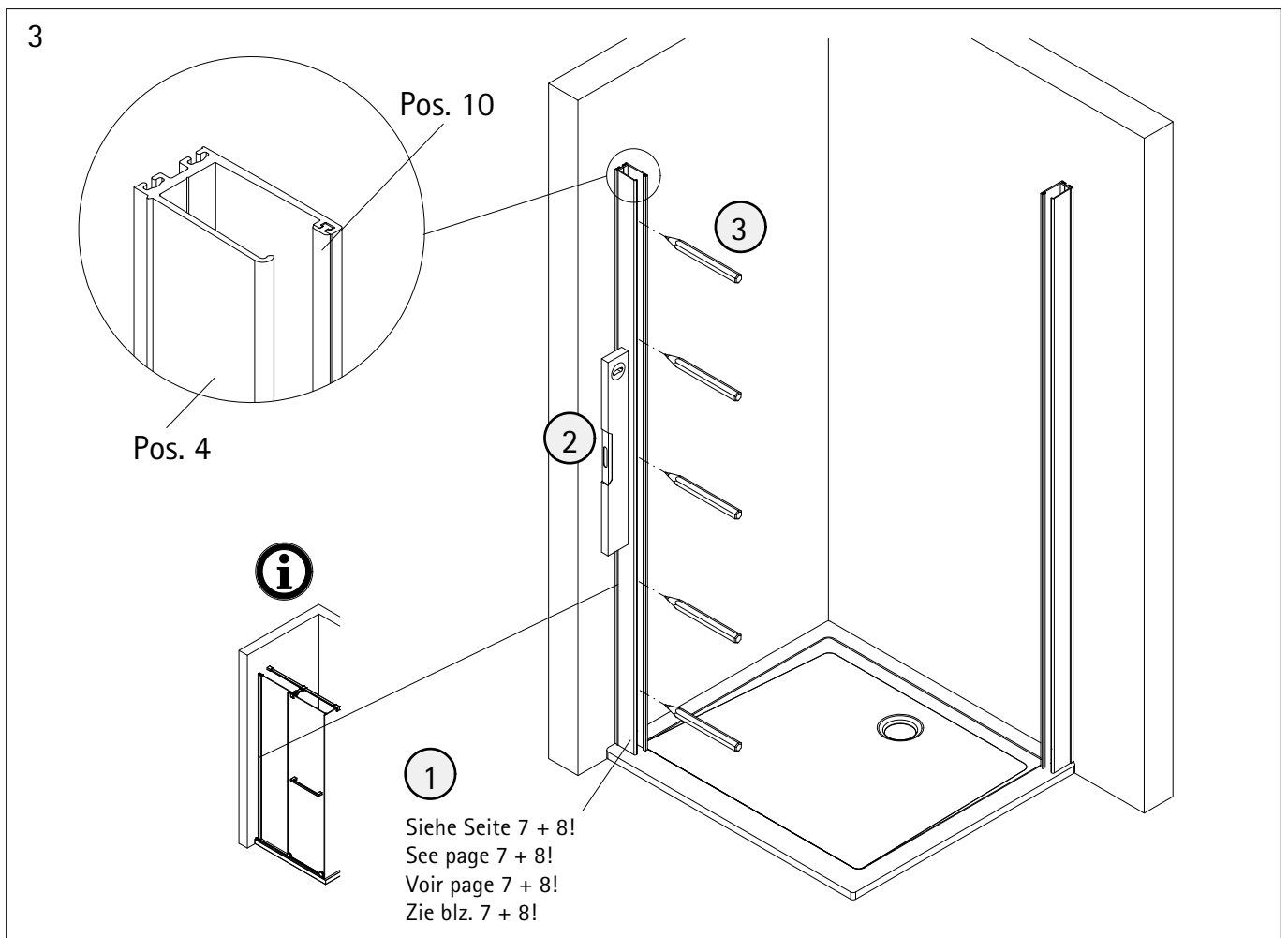
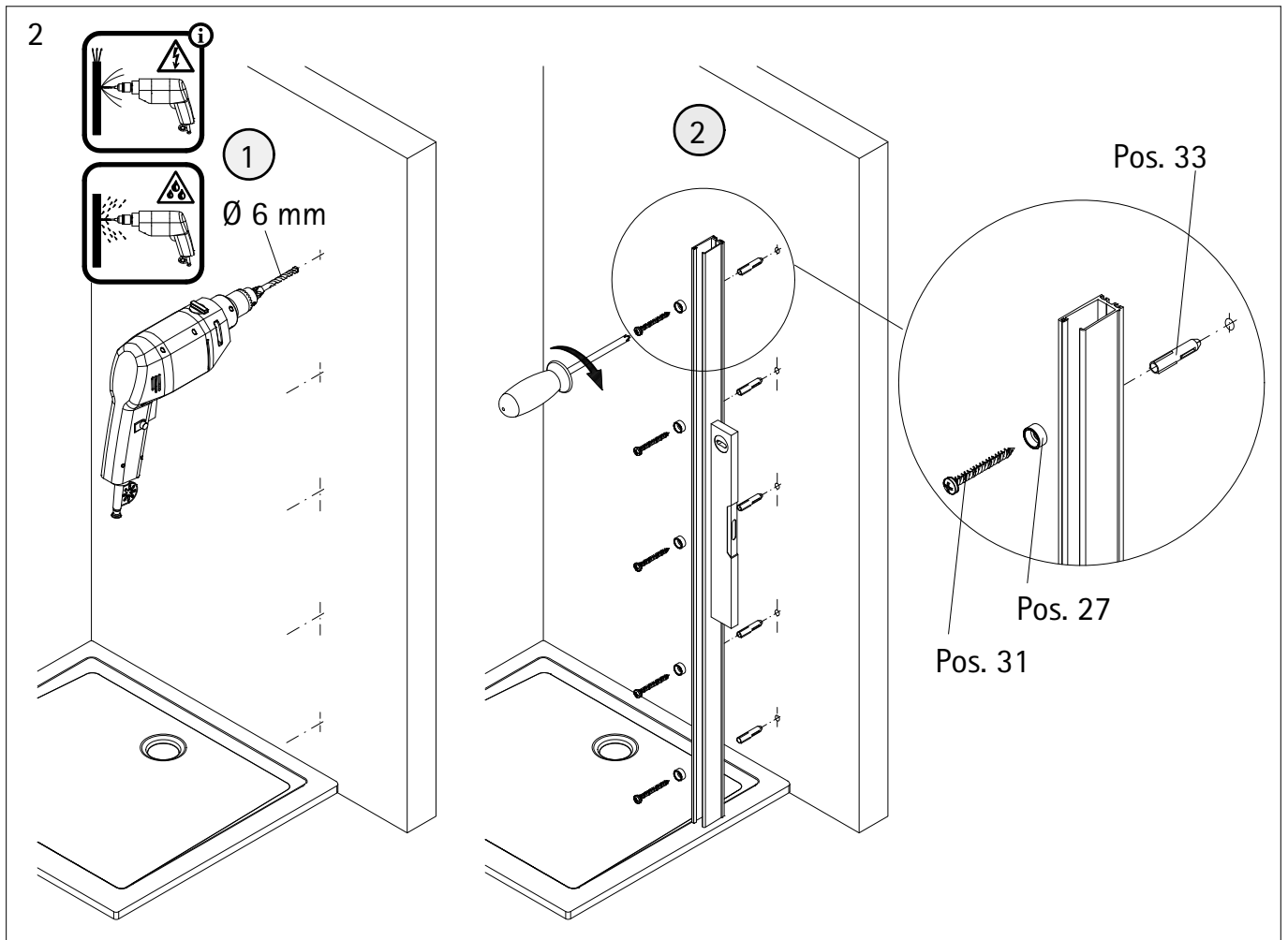

4

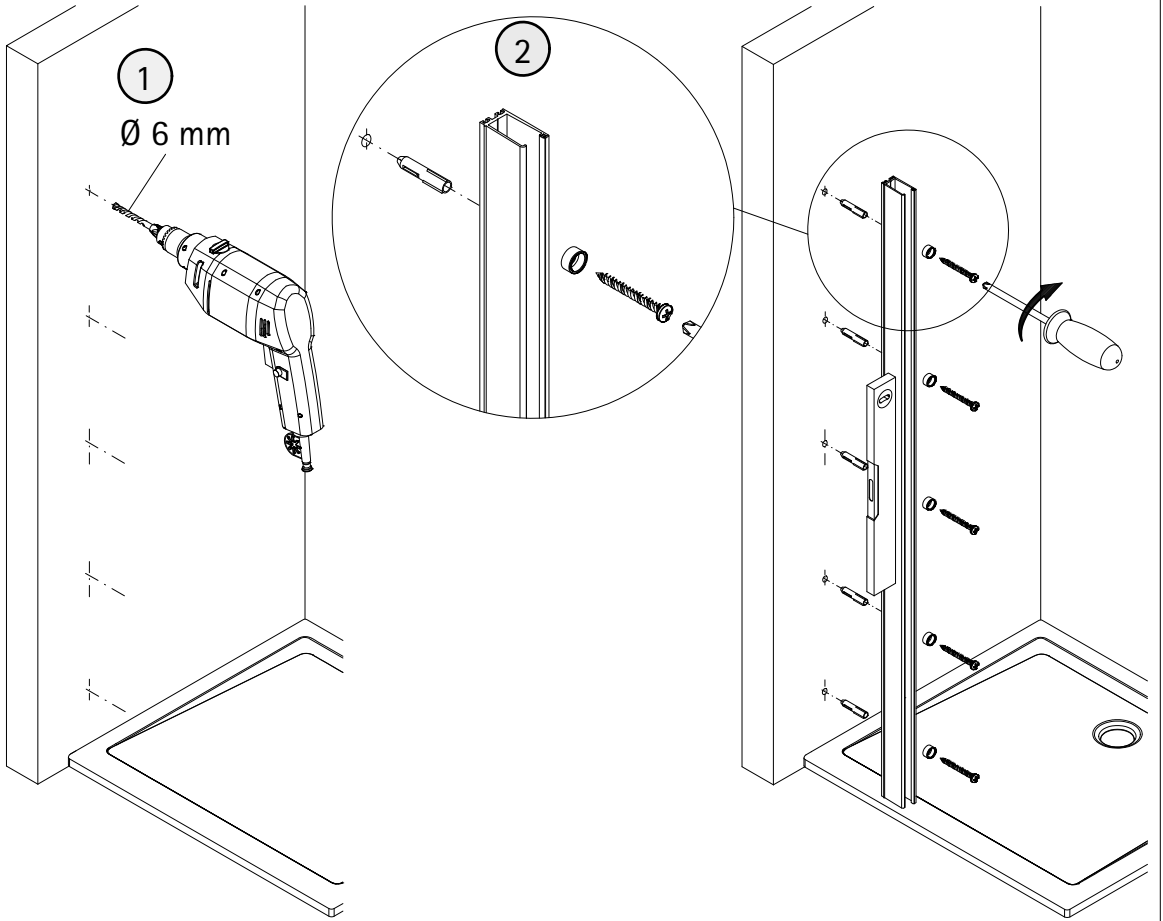
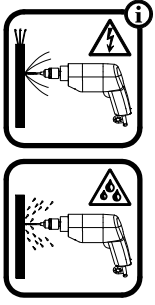

5

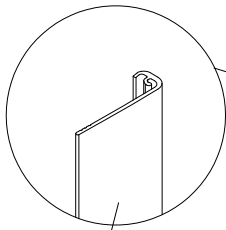

Pos. 5

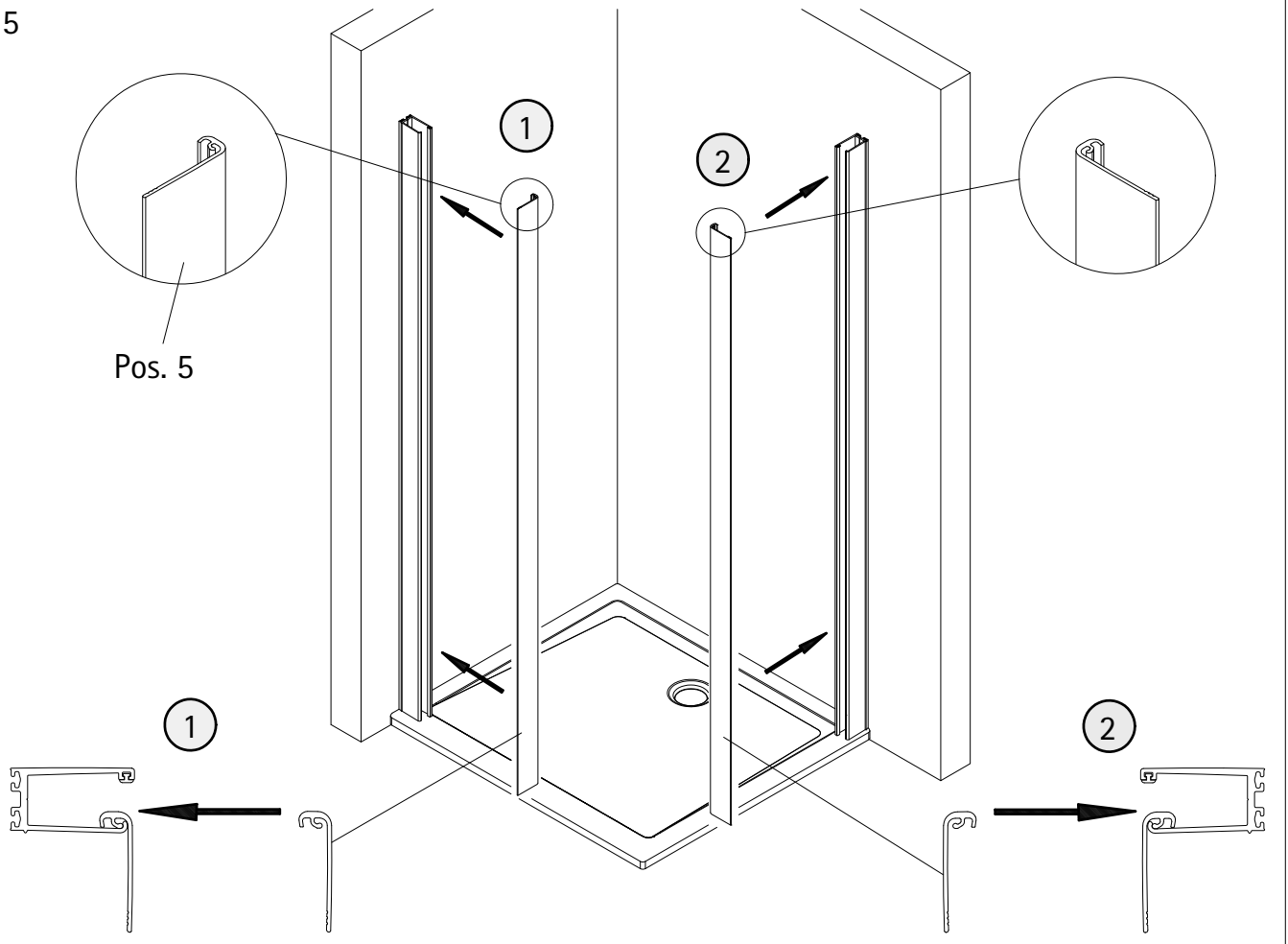

6

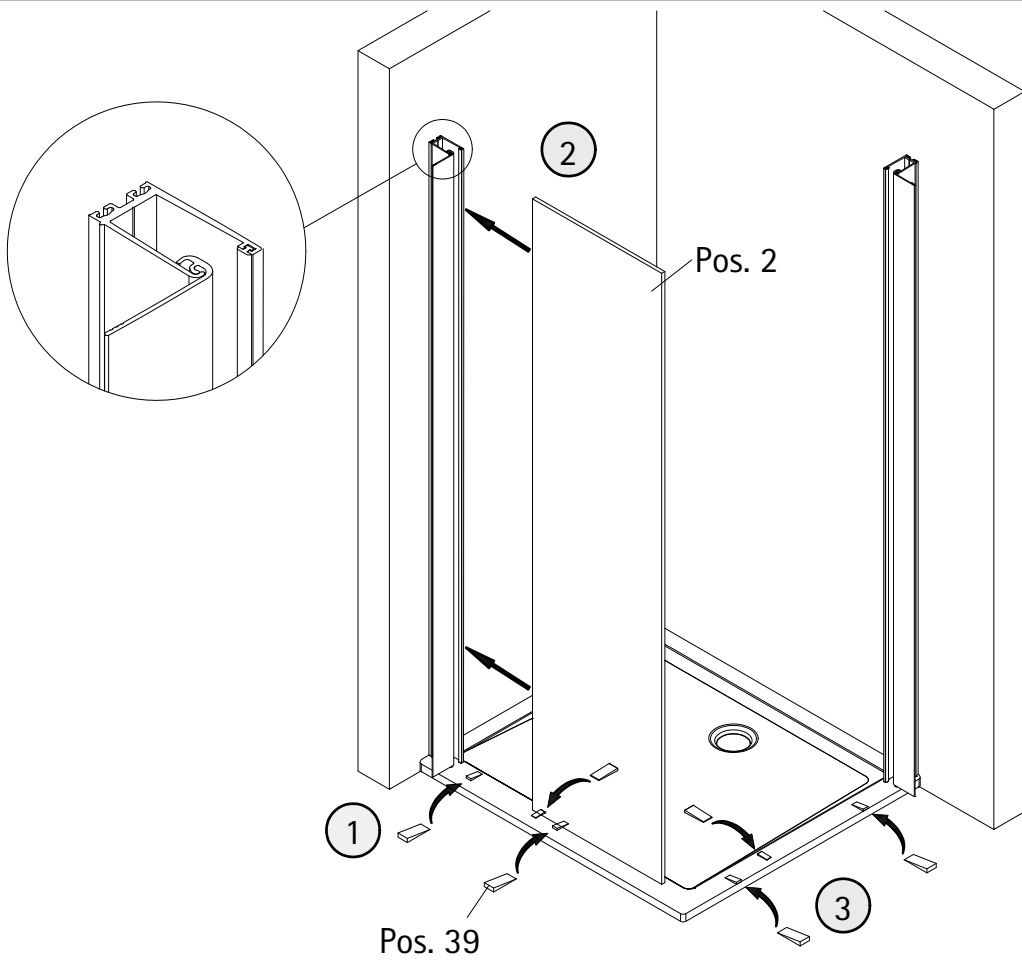

7

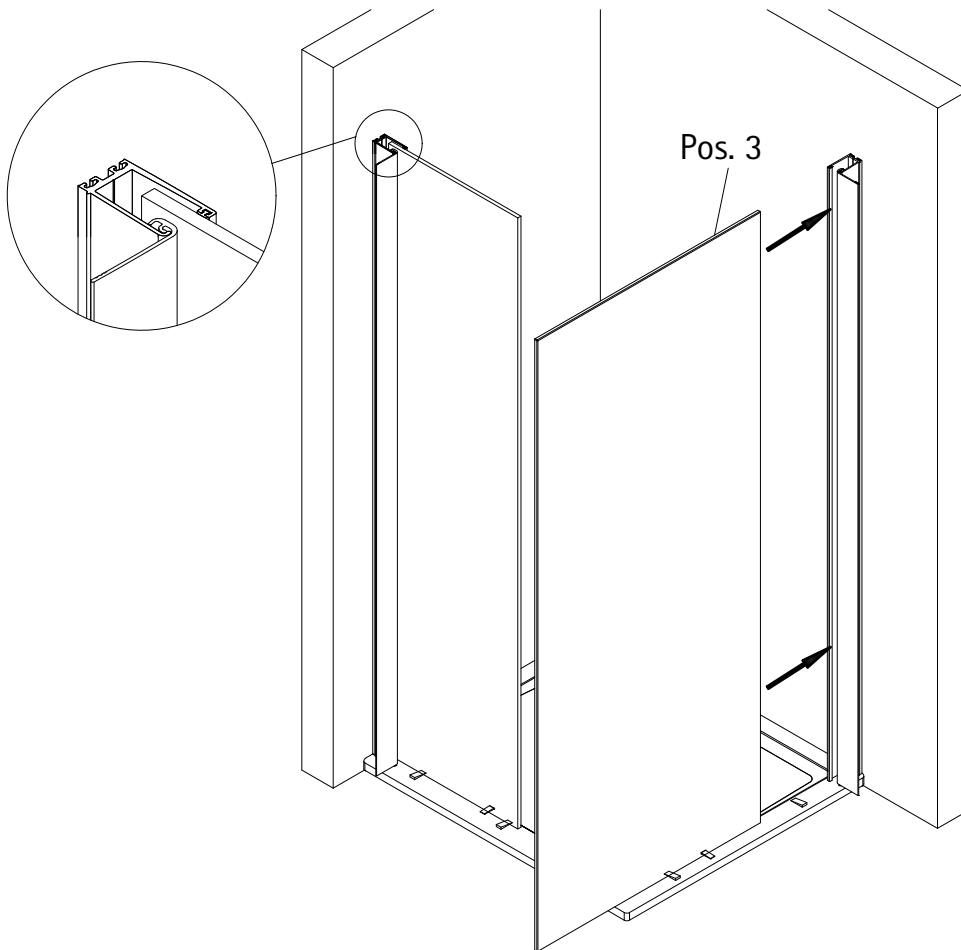

8

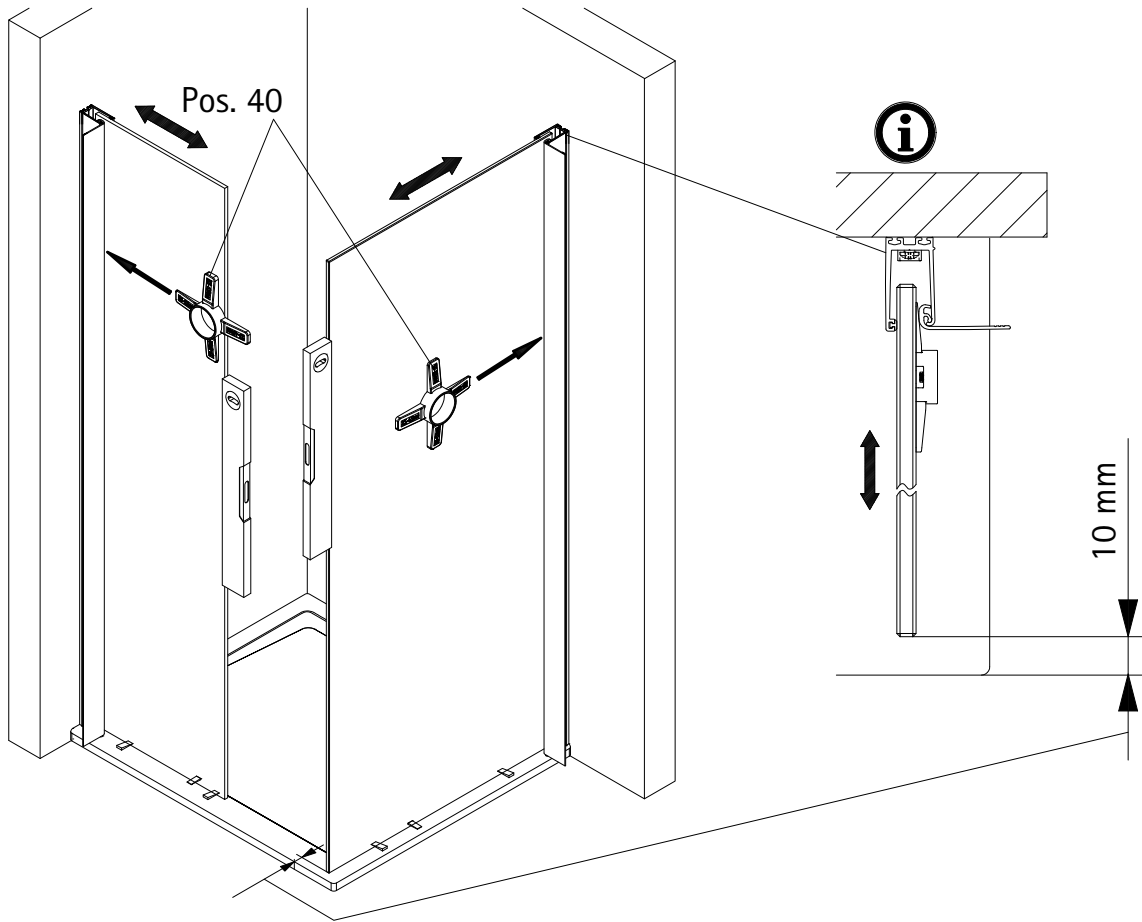

9

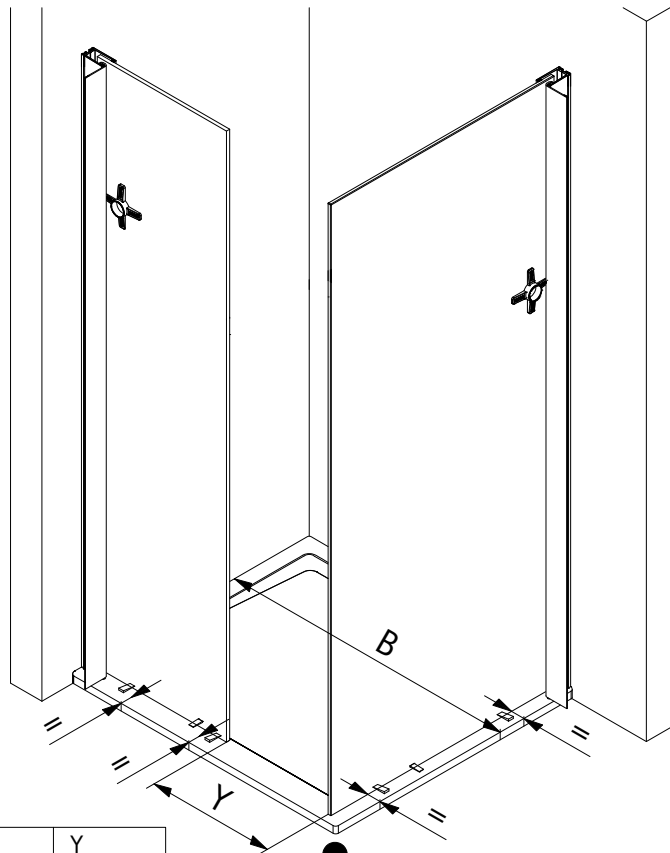

B	Y
1000 mm	443 mm
1200 mm	543 mm
1400 mm	643 mm
1600 mm	743 mm

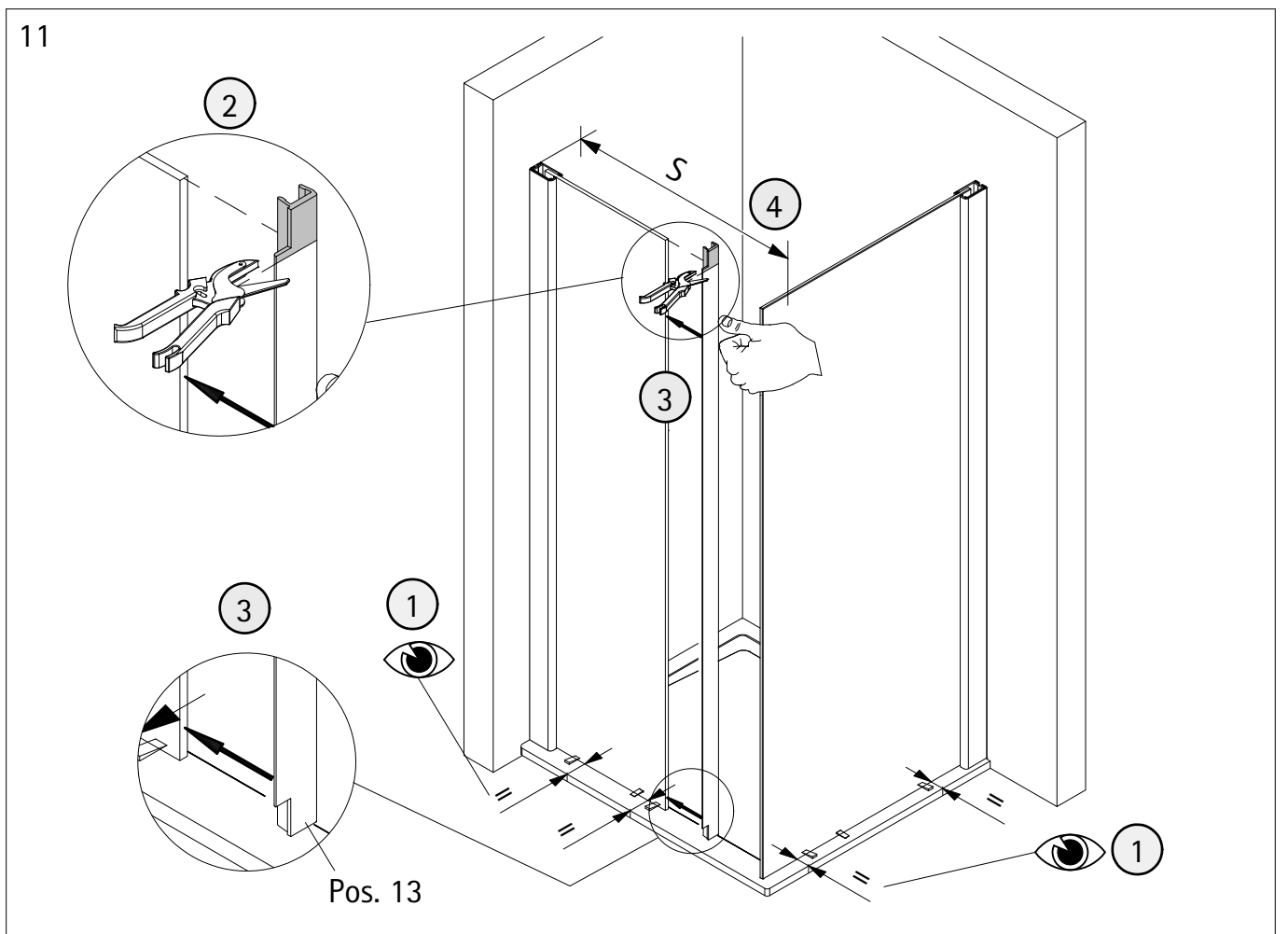
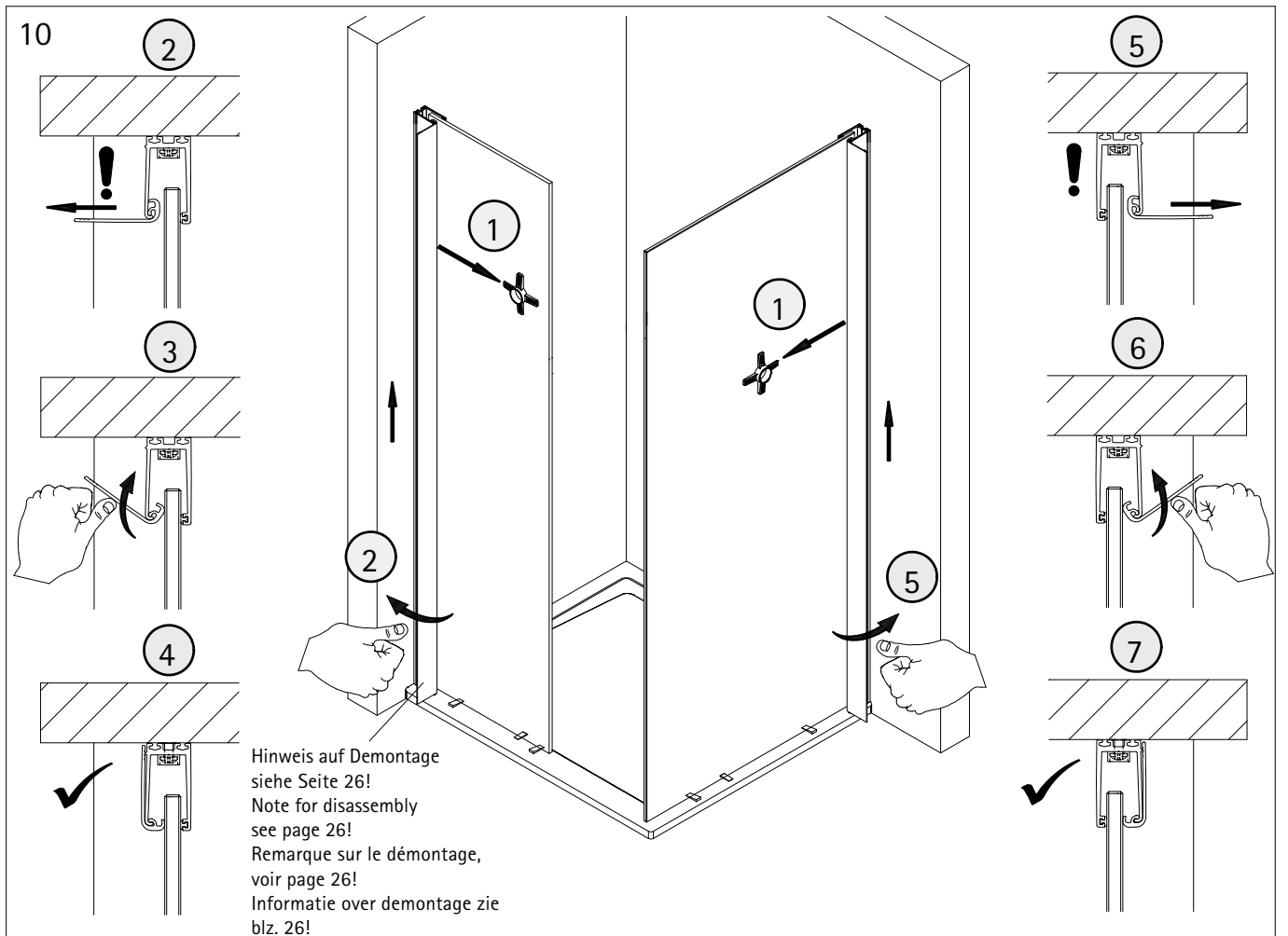

12

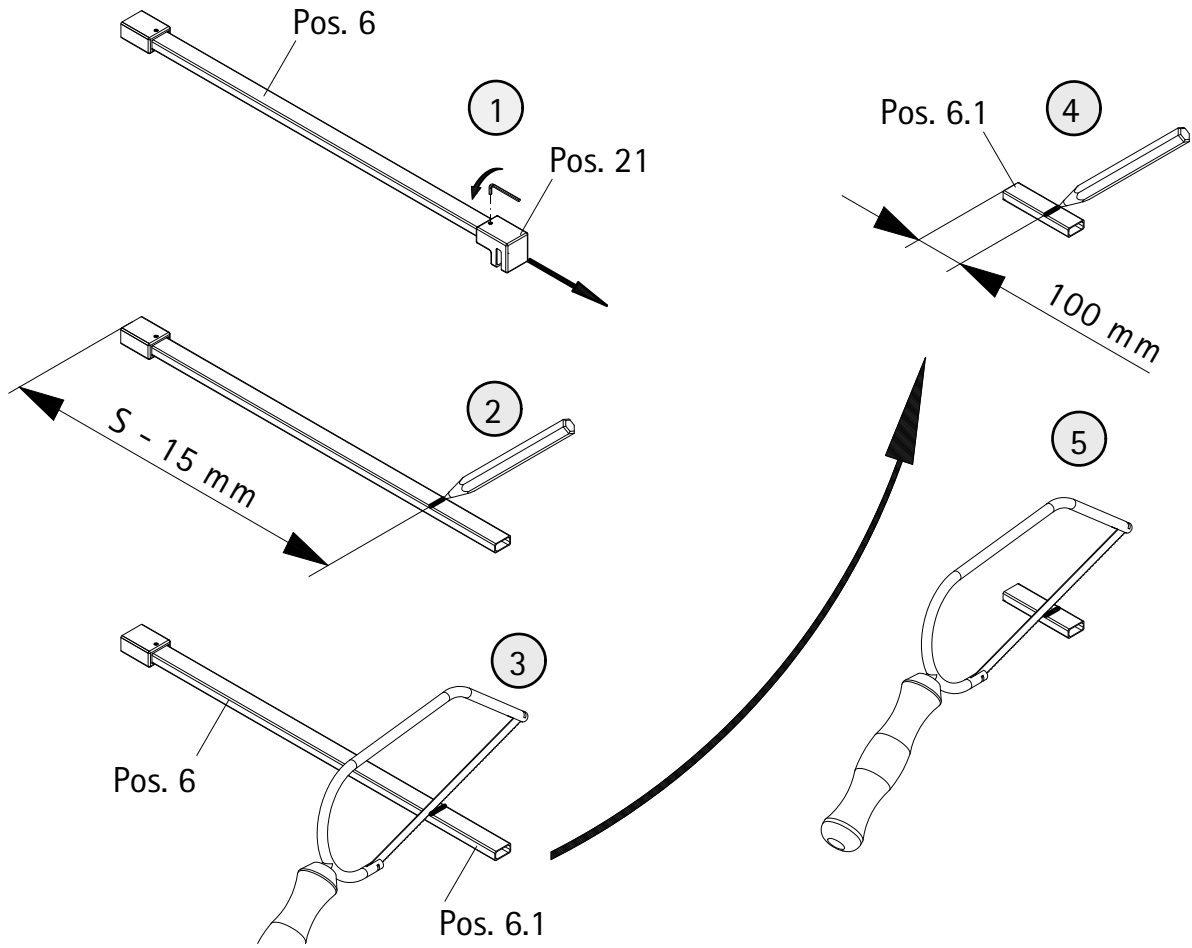

13

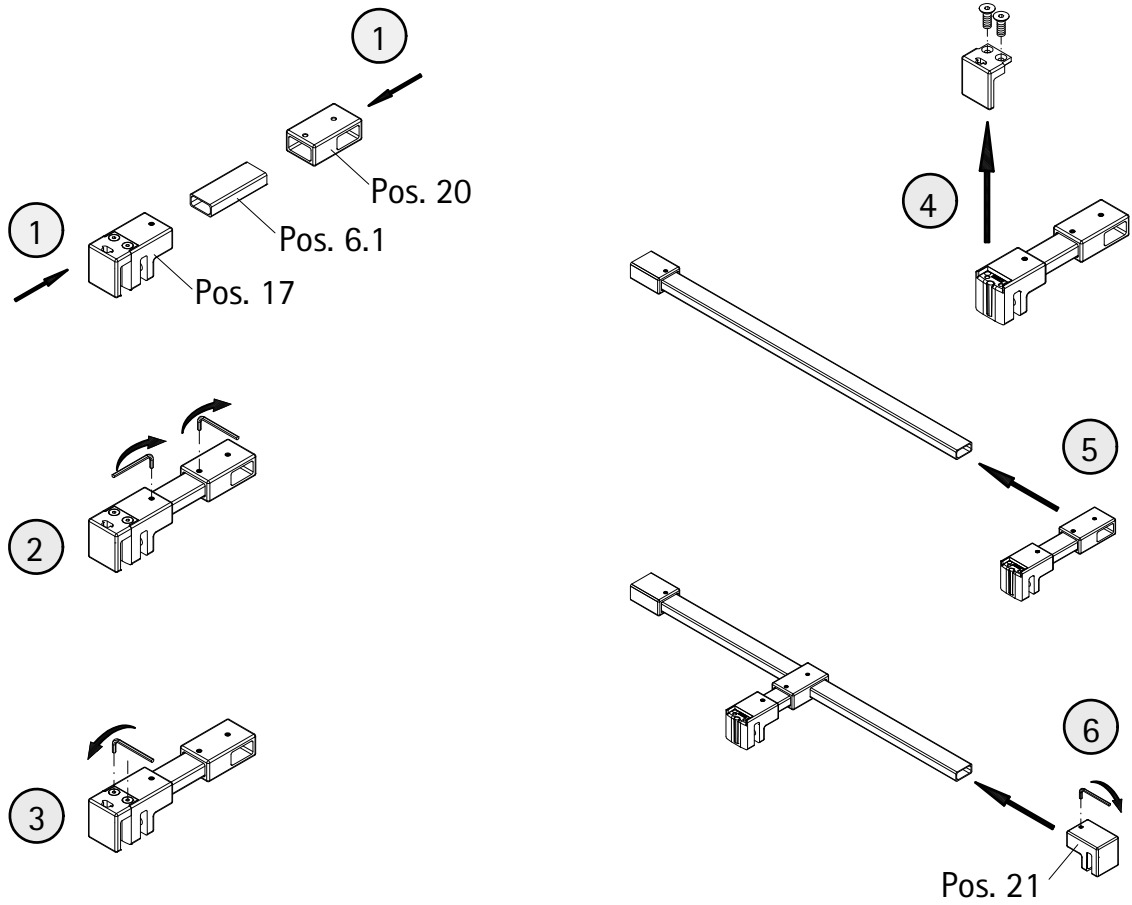

14

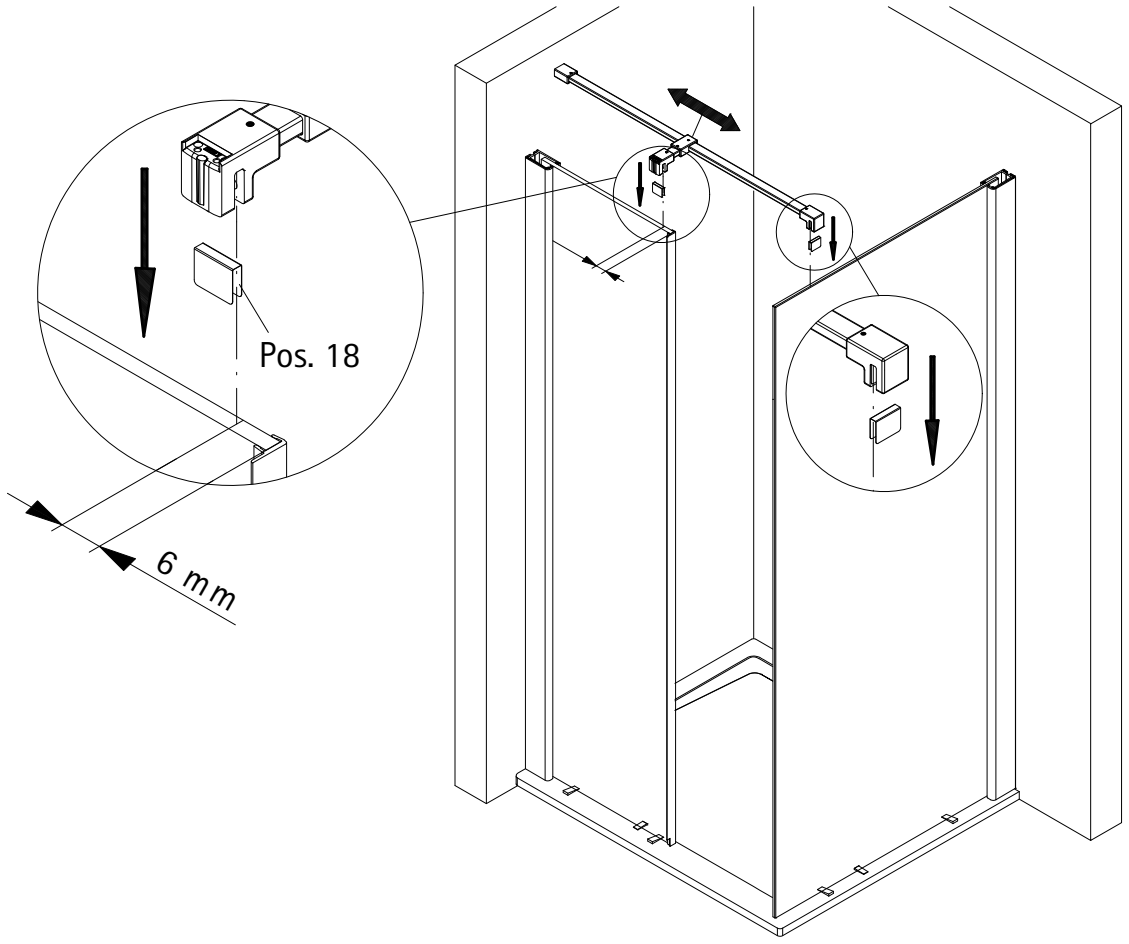

15

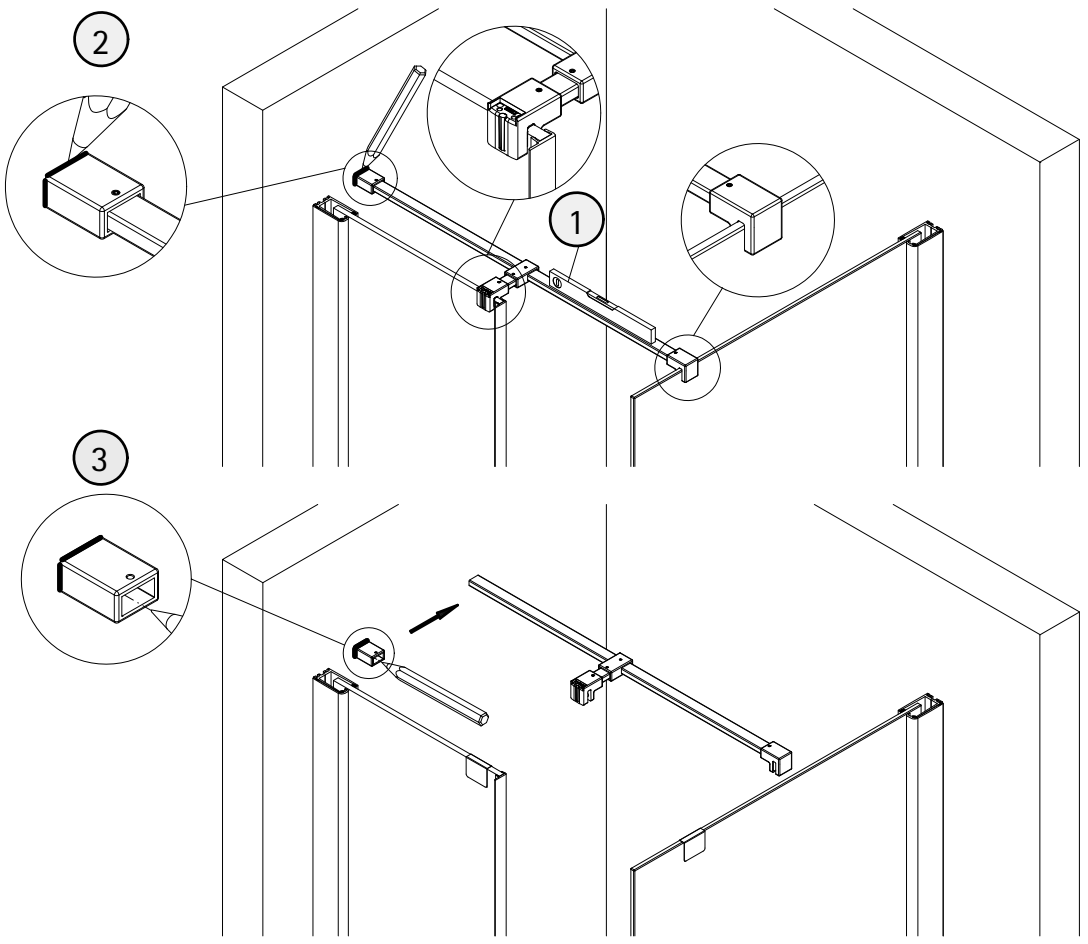

16

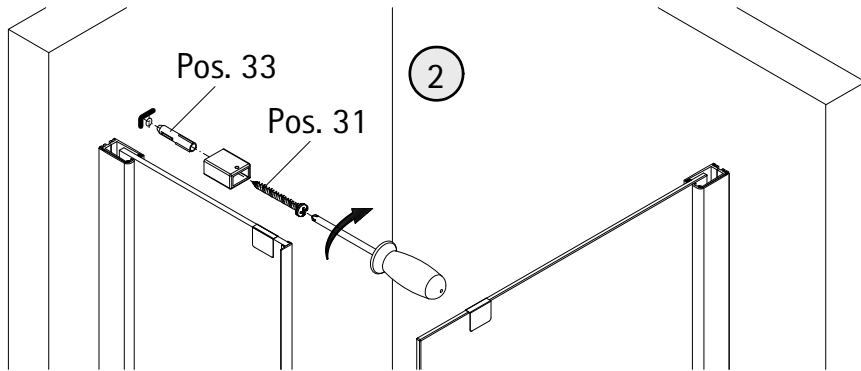
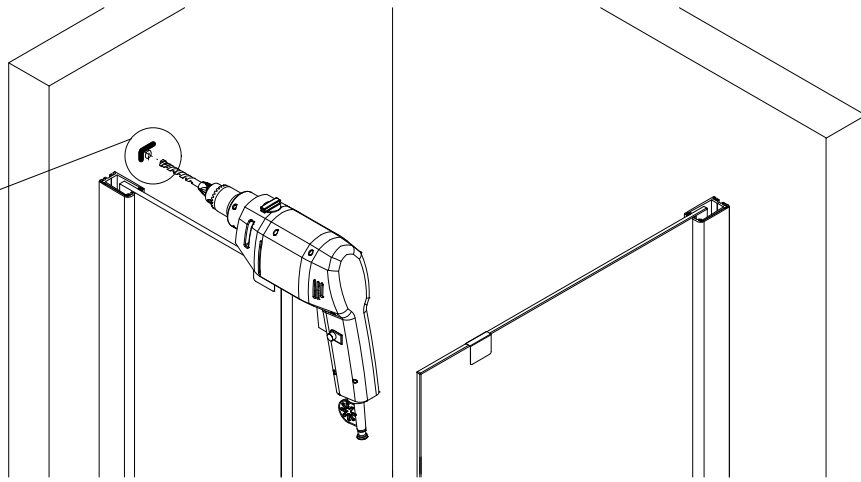
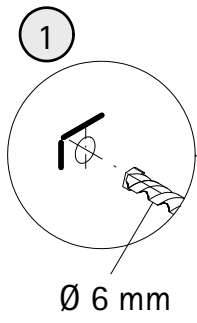

17

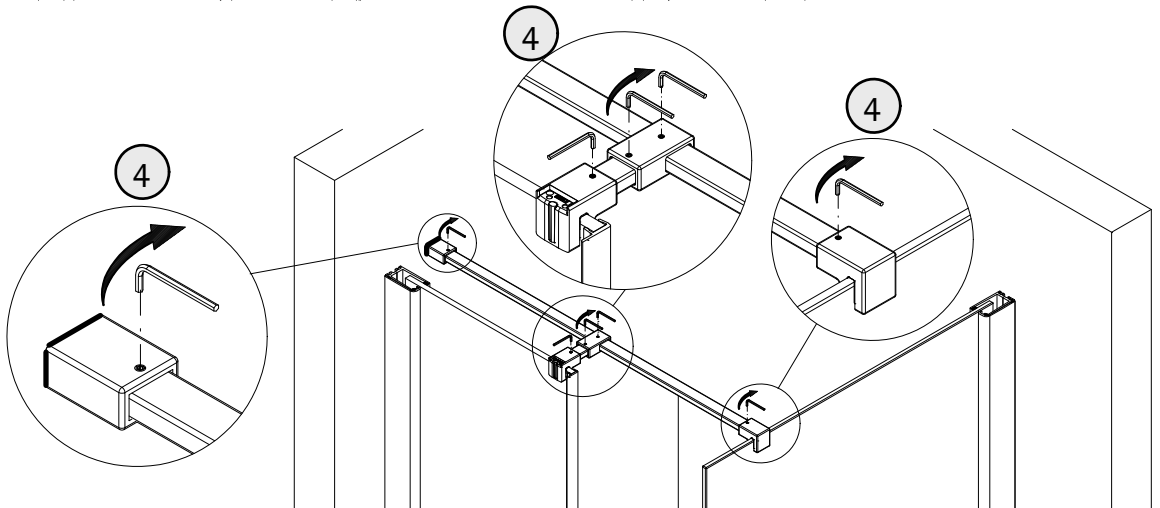
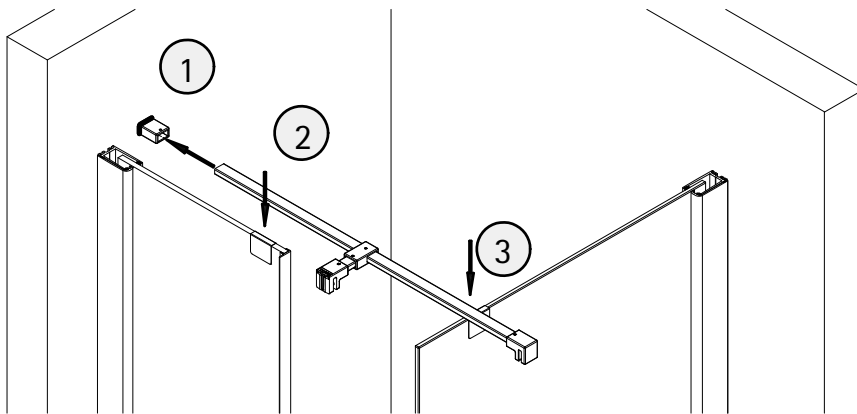

18

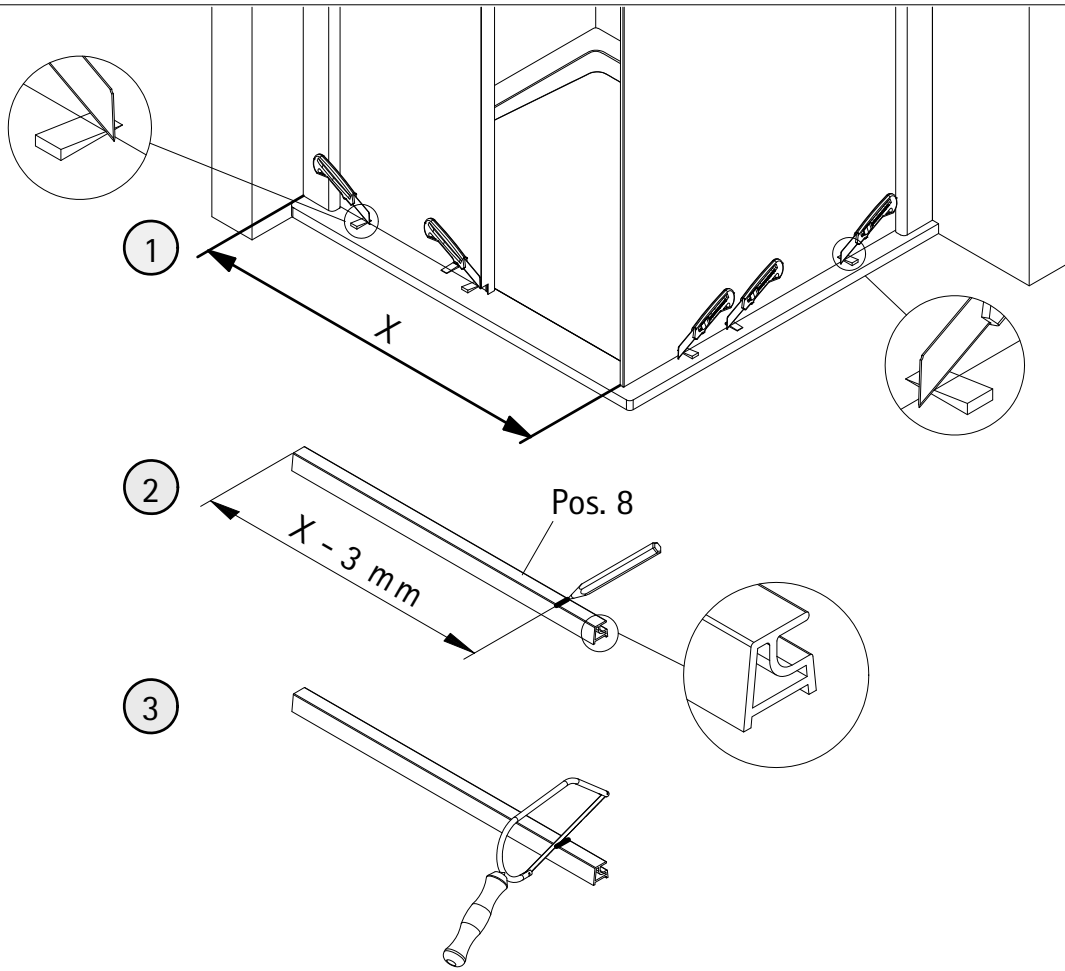

19

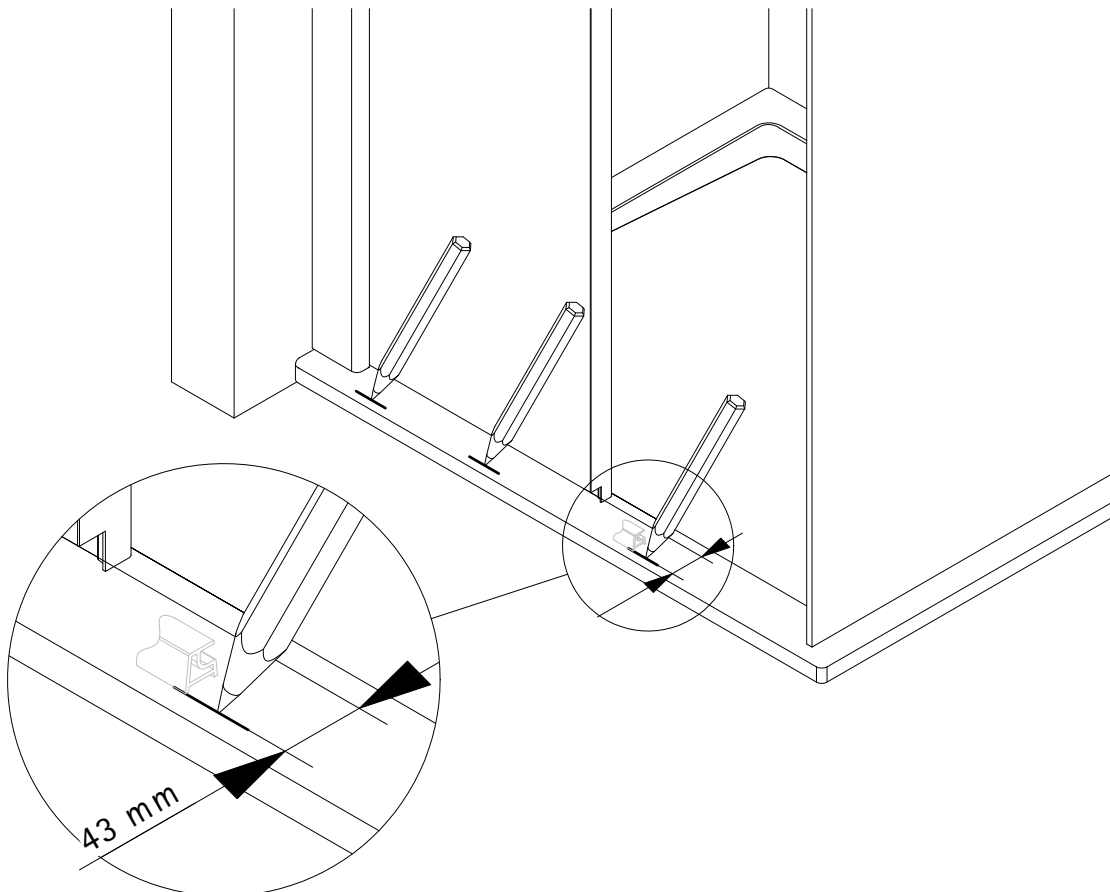

20

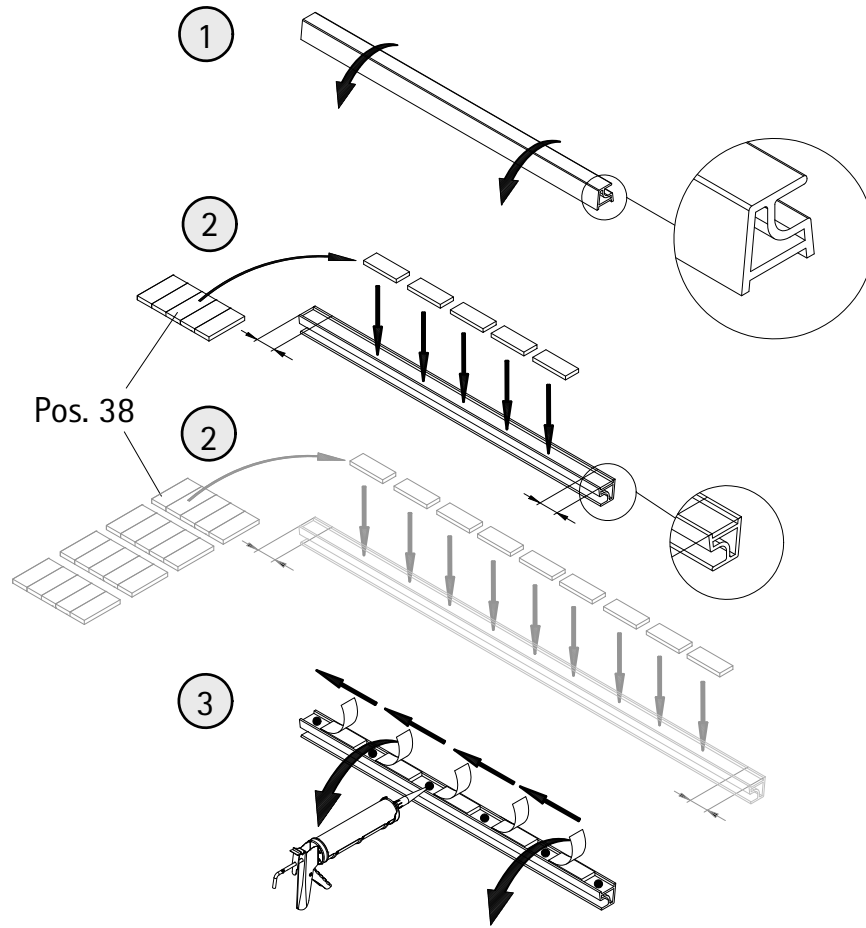

21

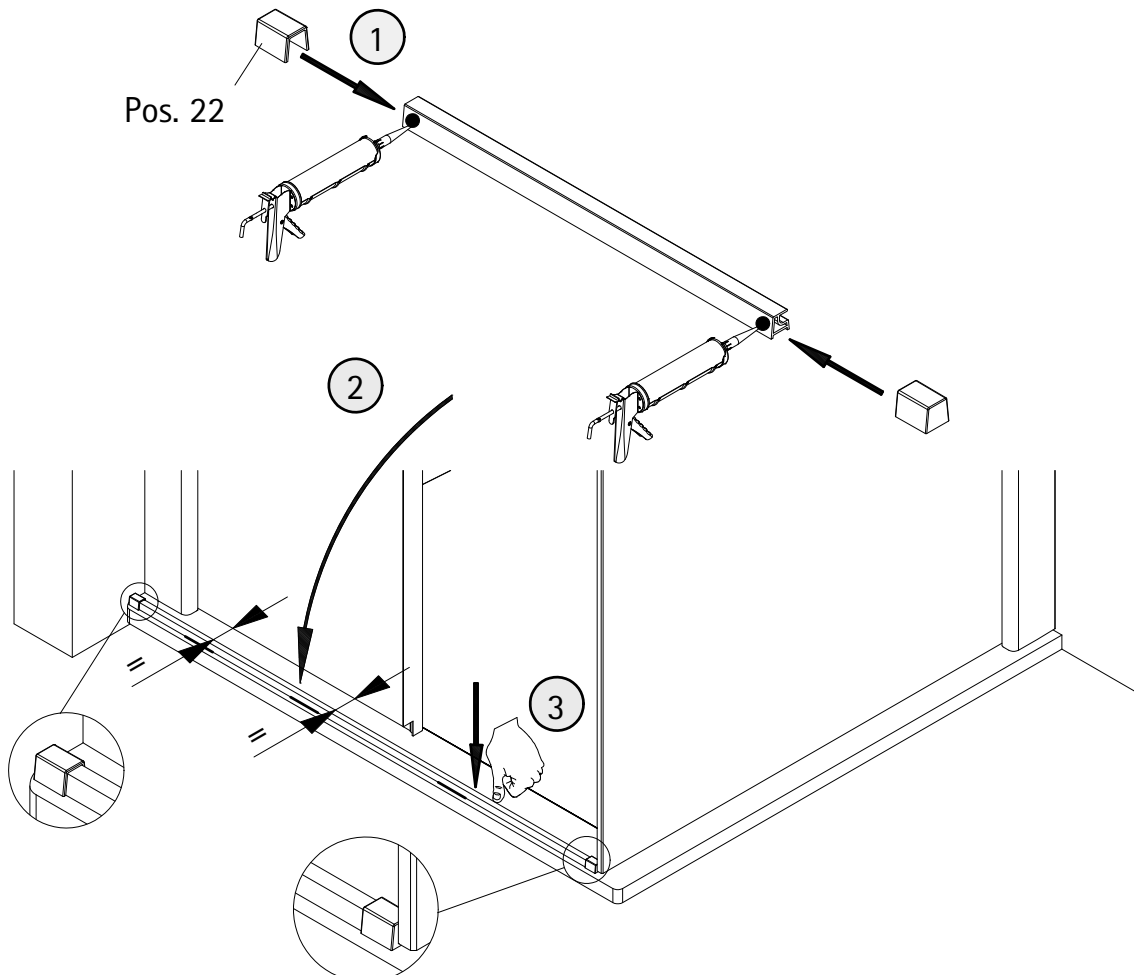

22

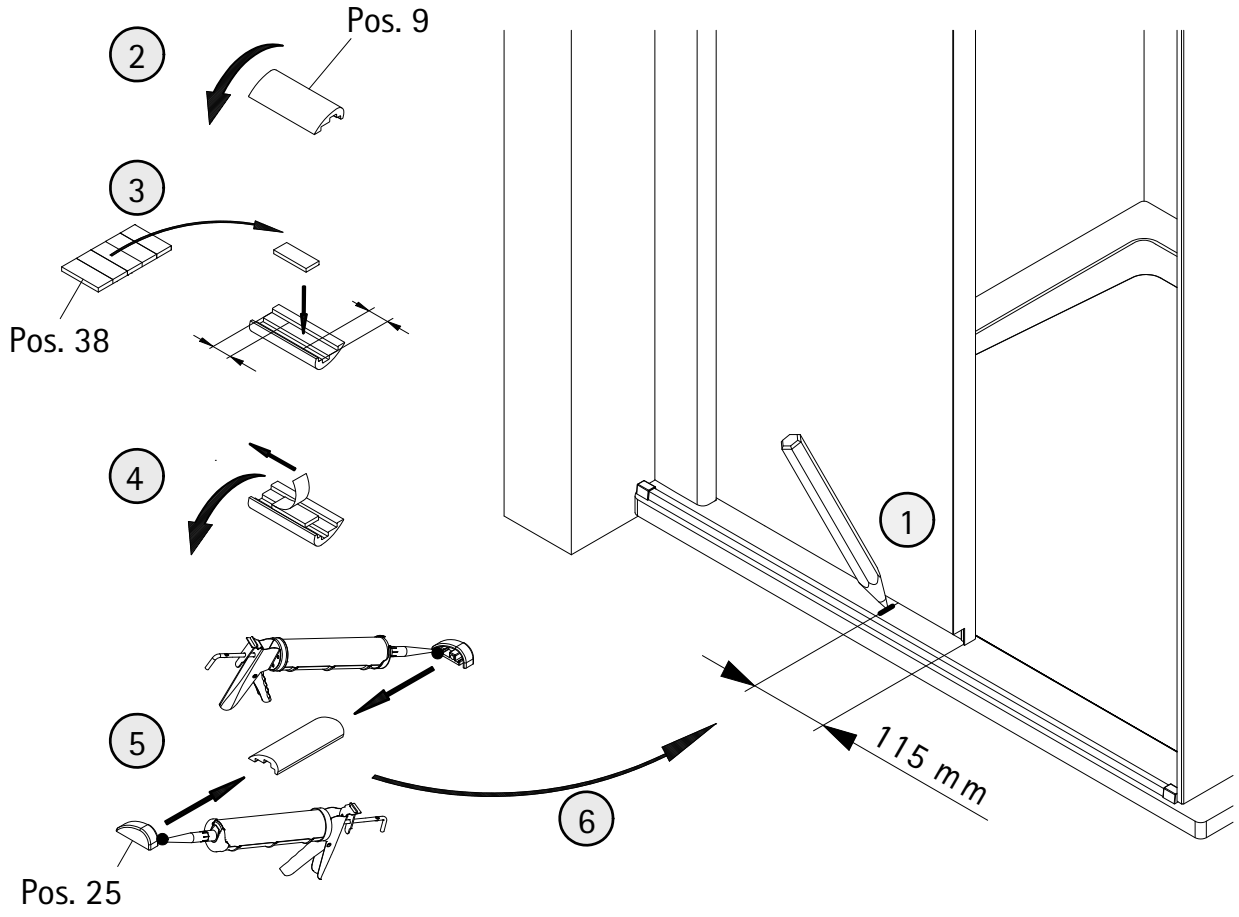

23

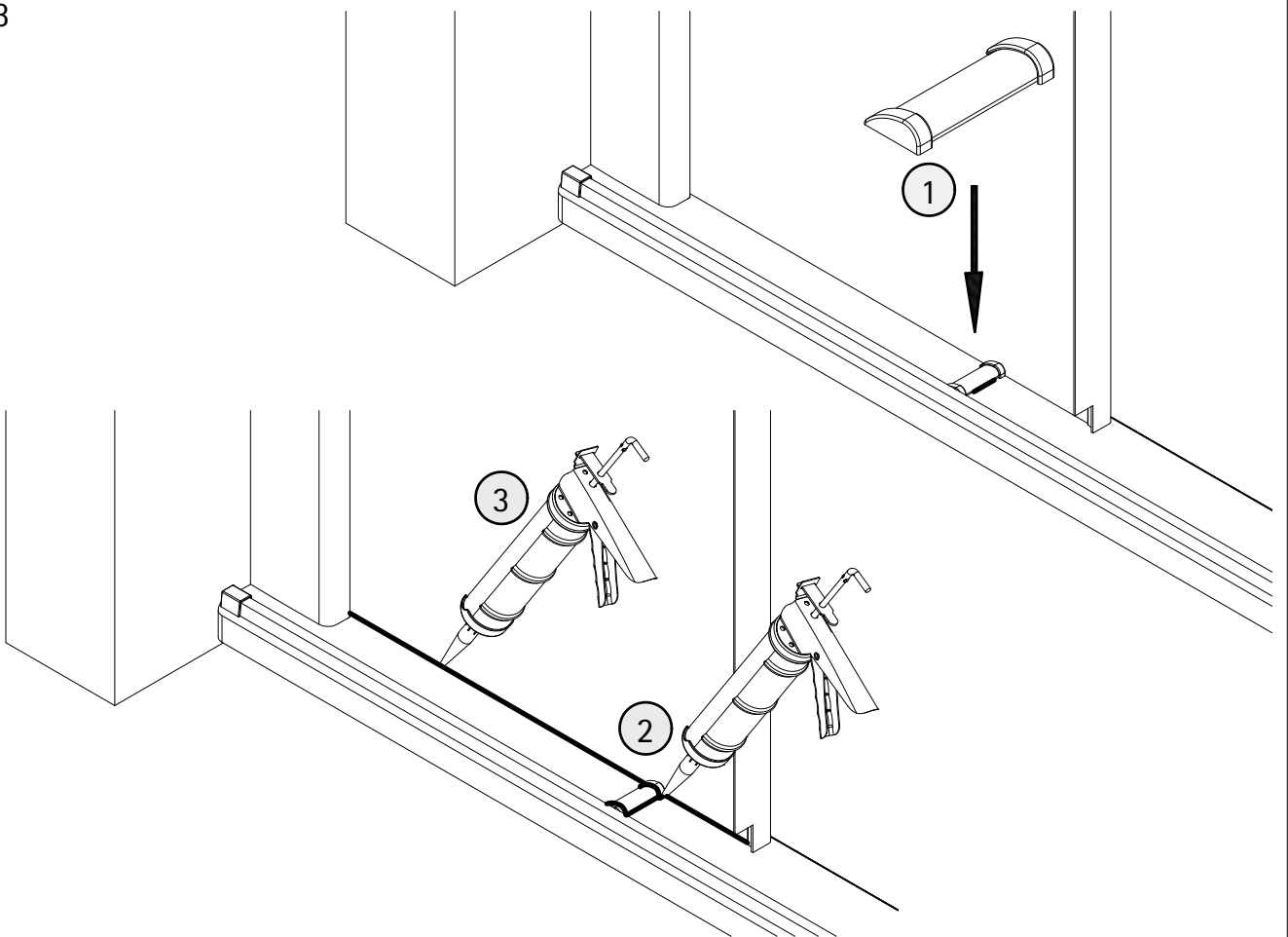

24

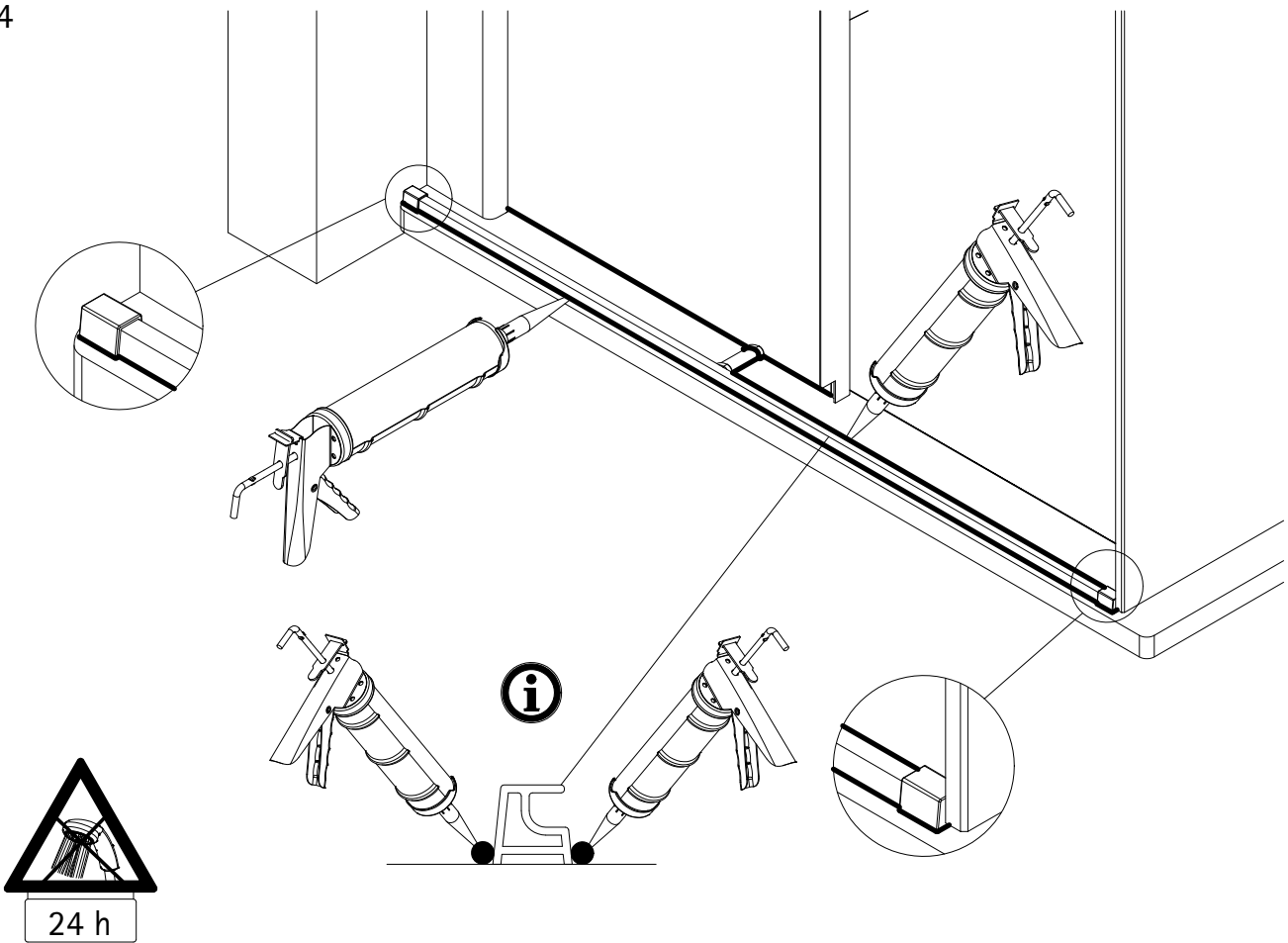

25

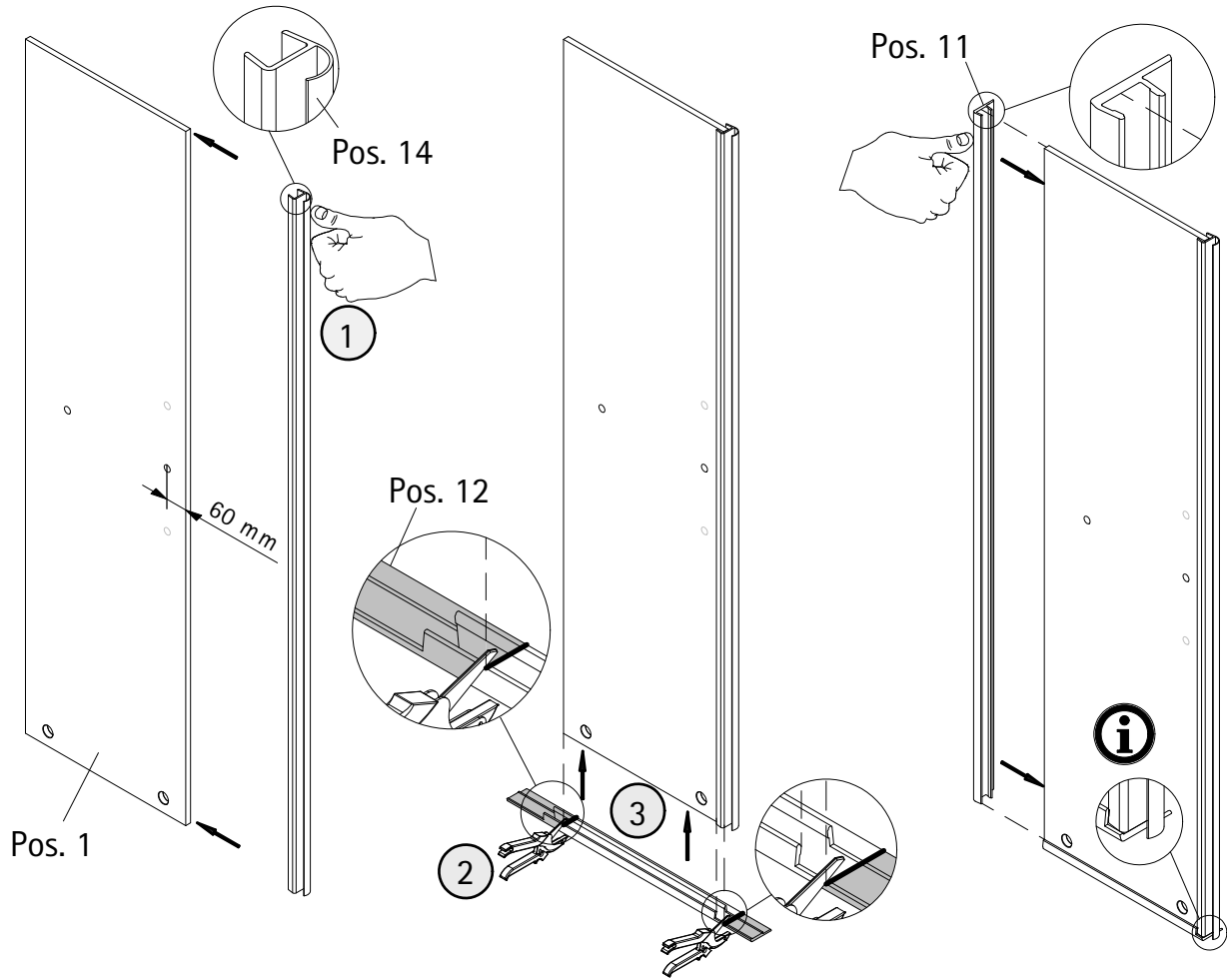

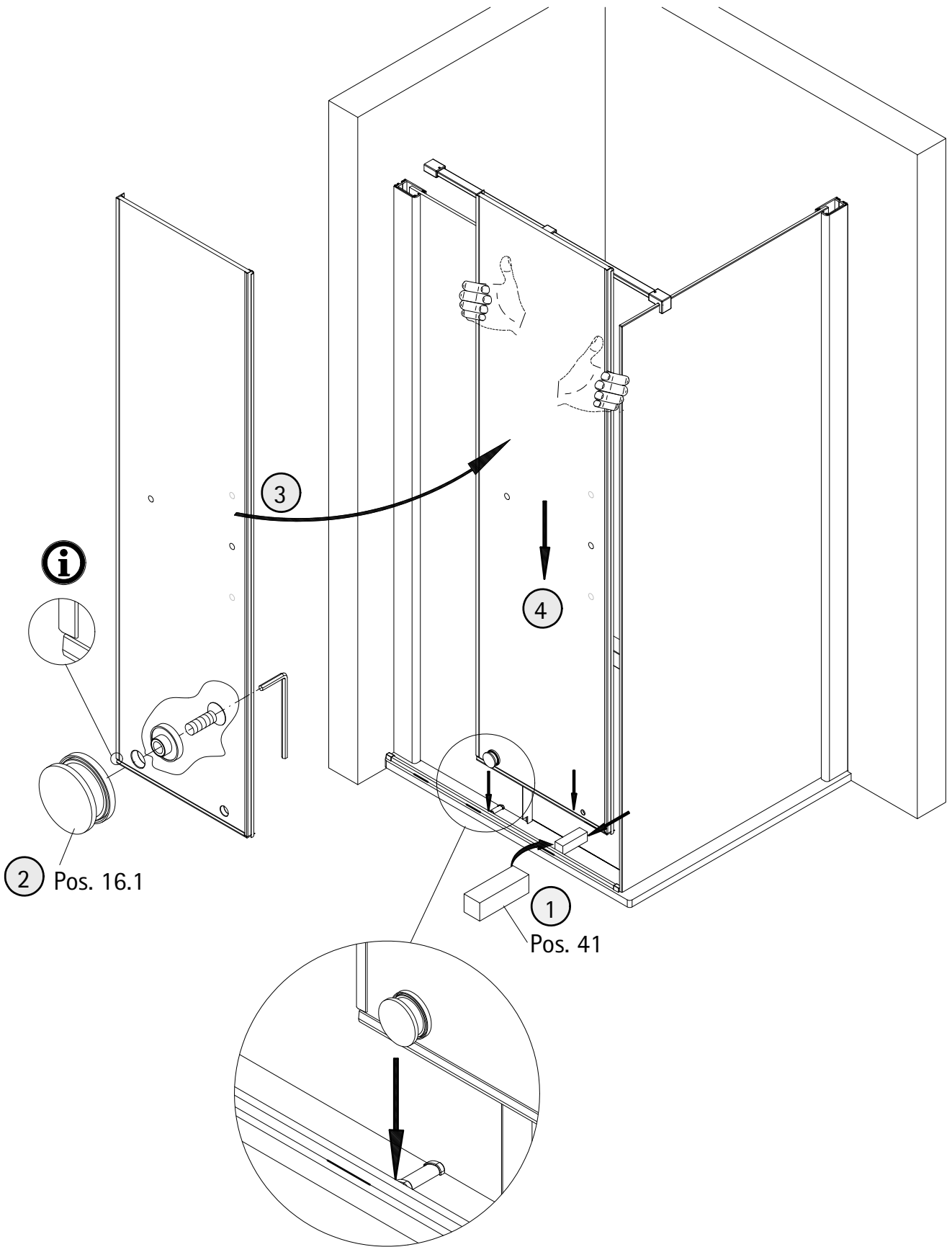

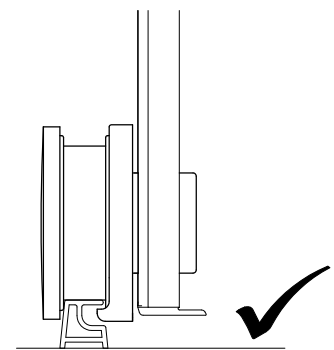
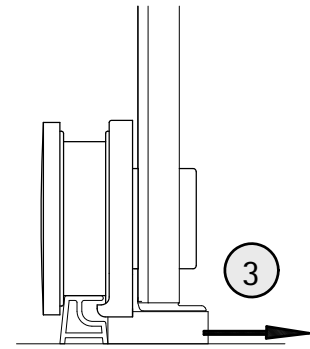
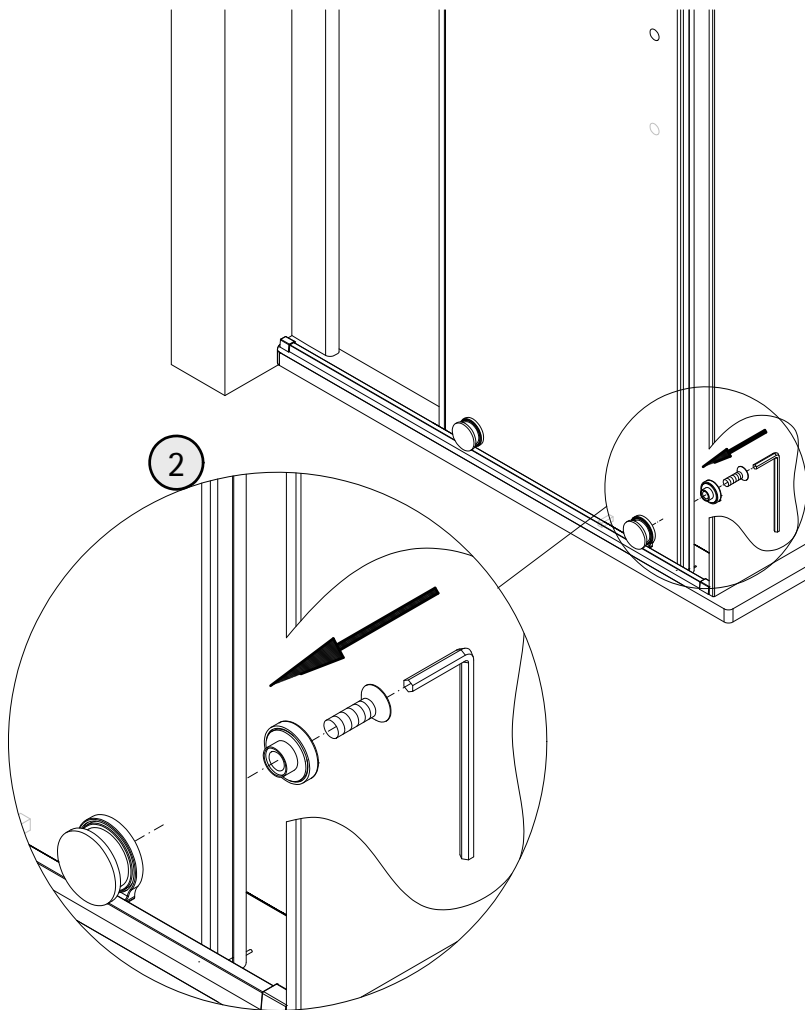
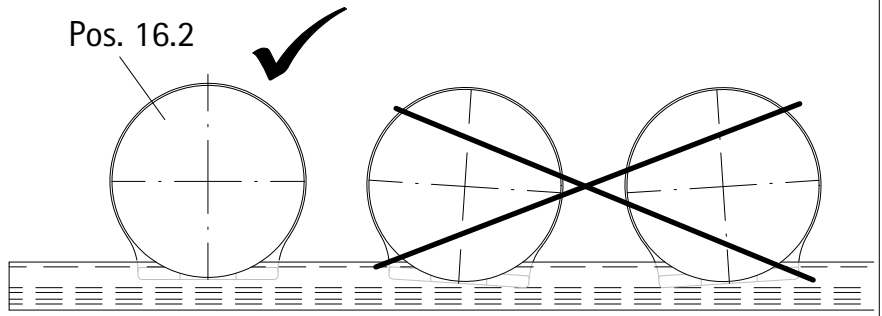
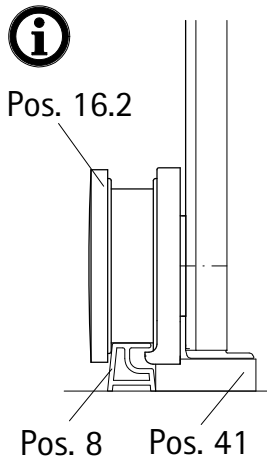
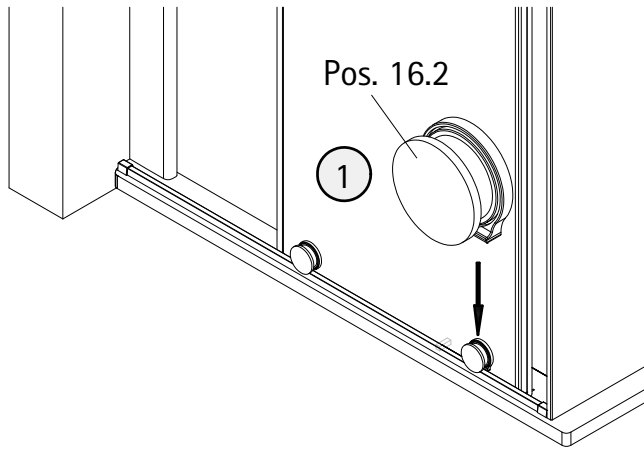

28

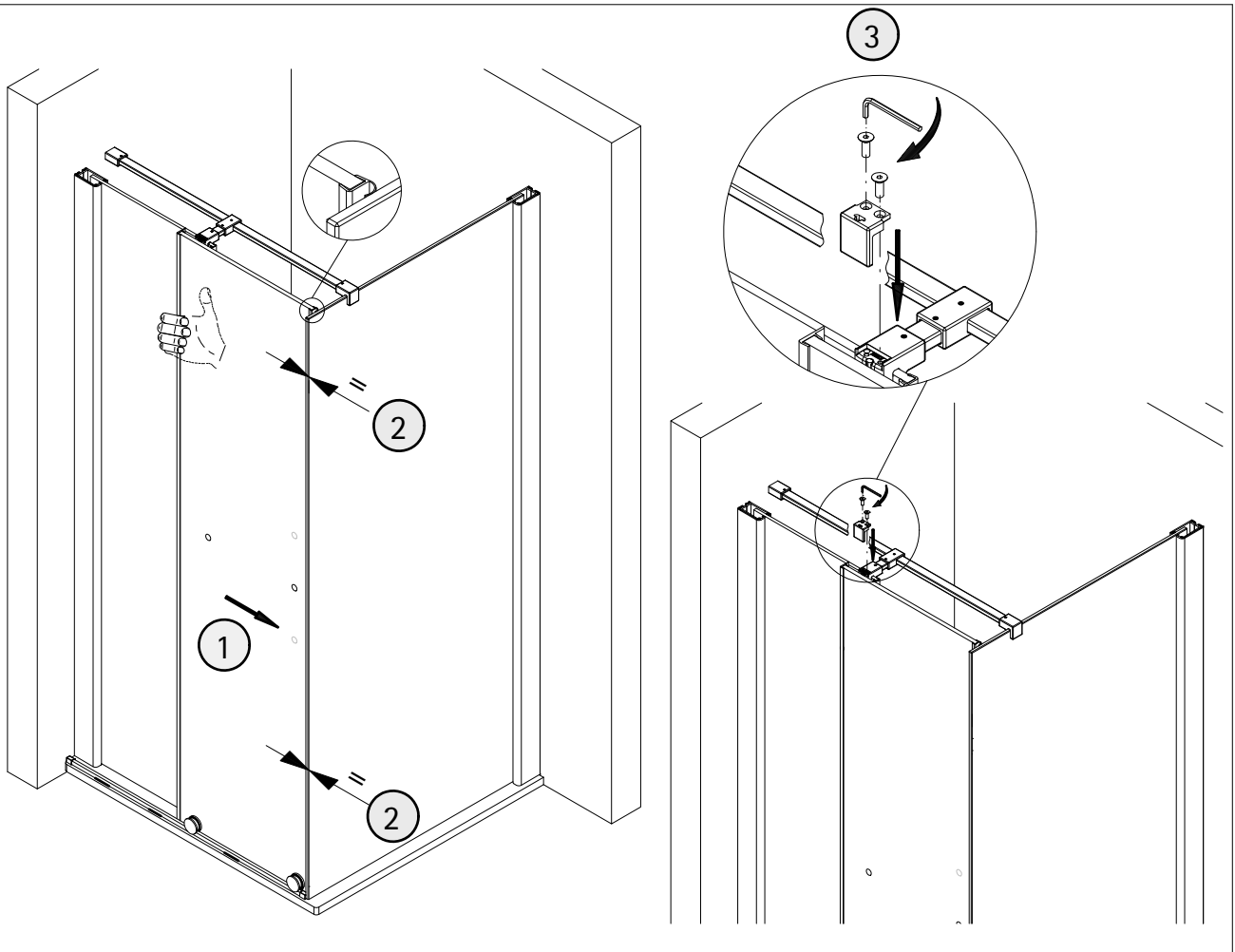

29

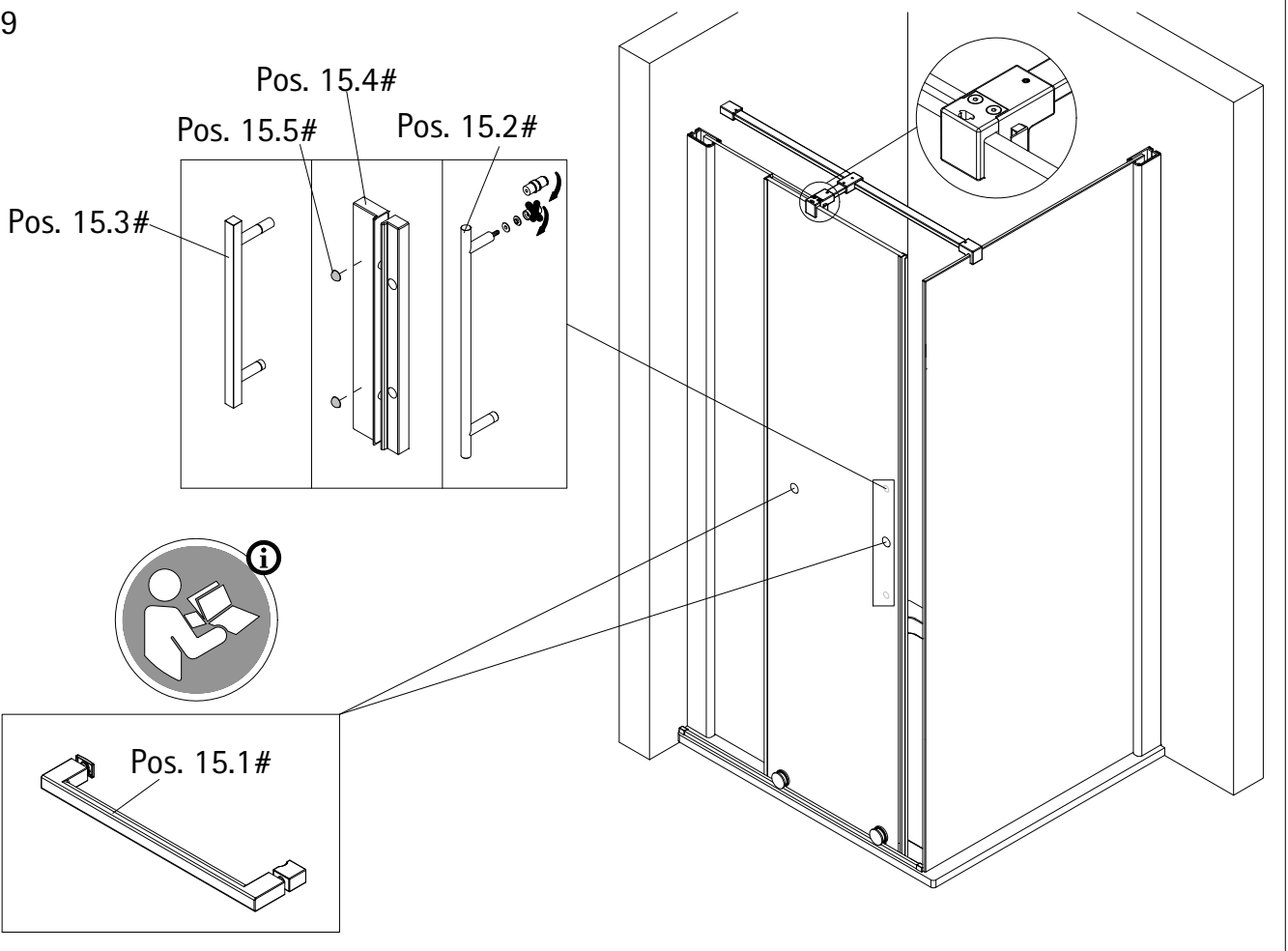

30

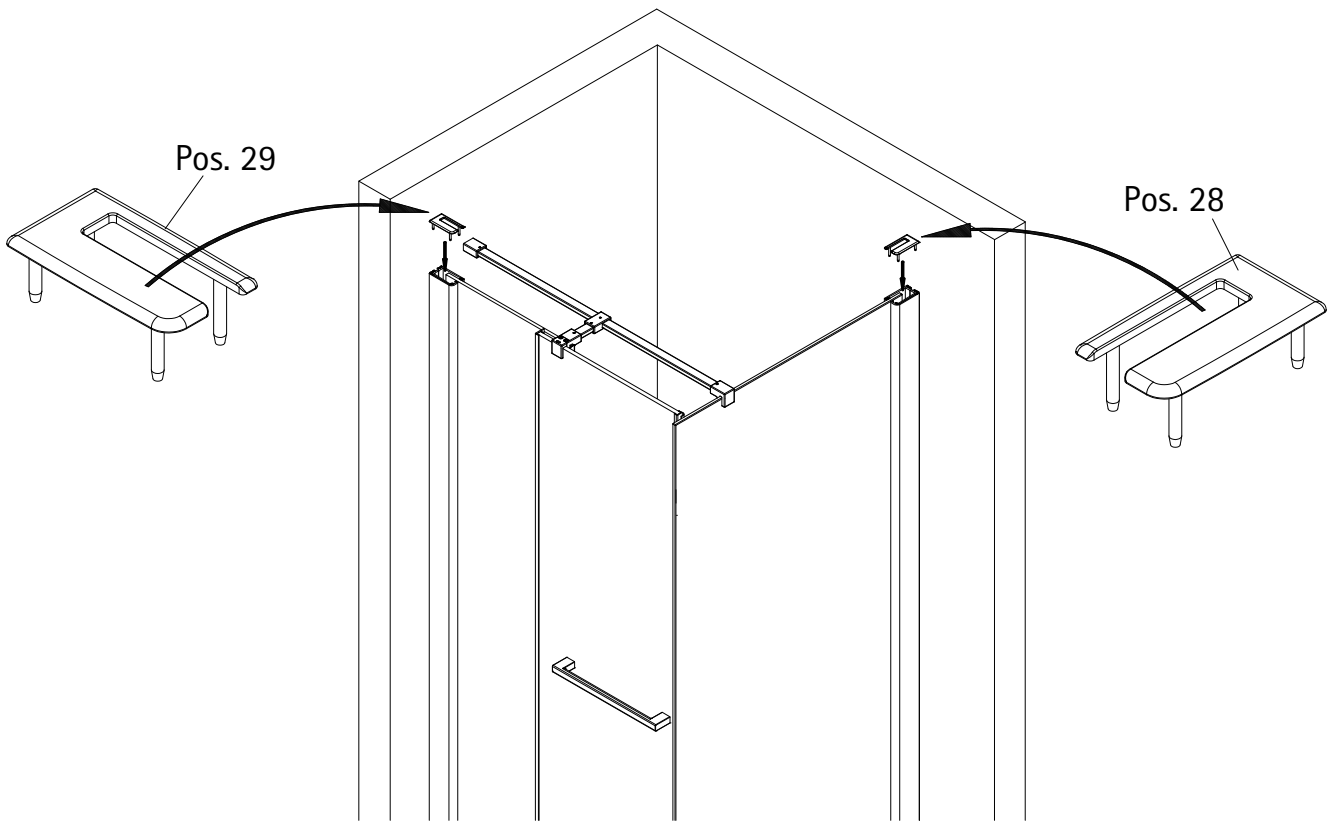

31

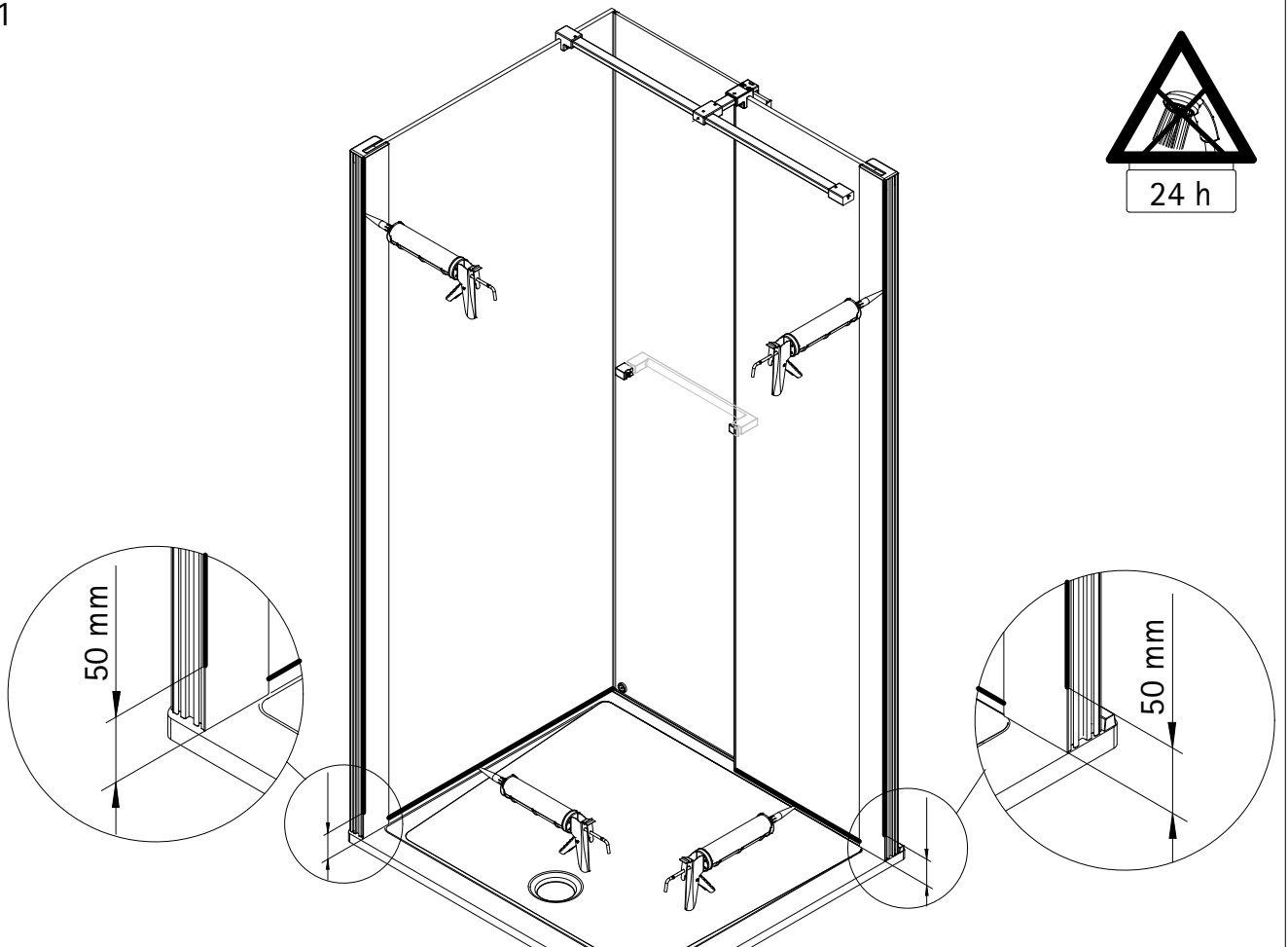

32

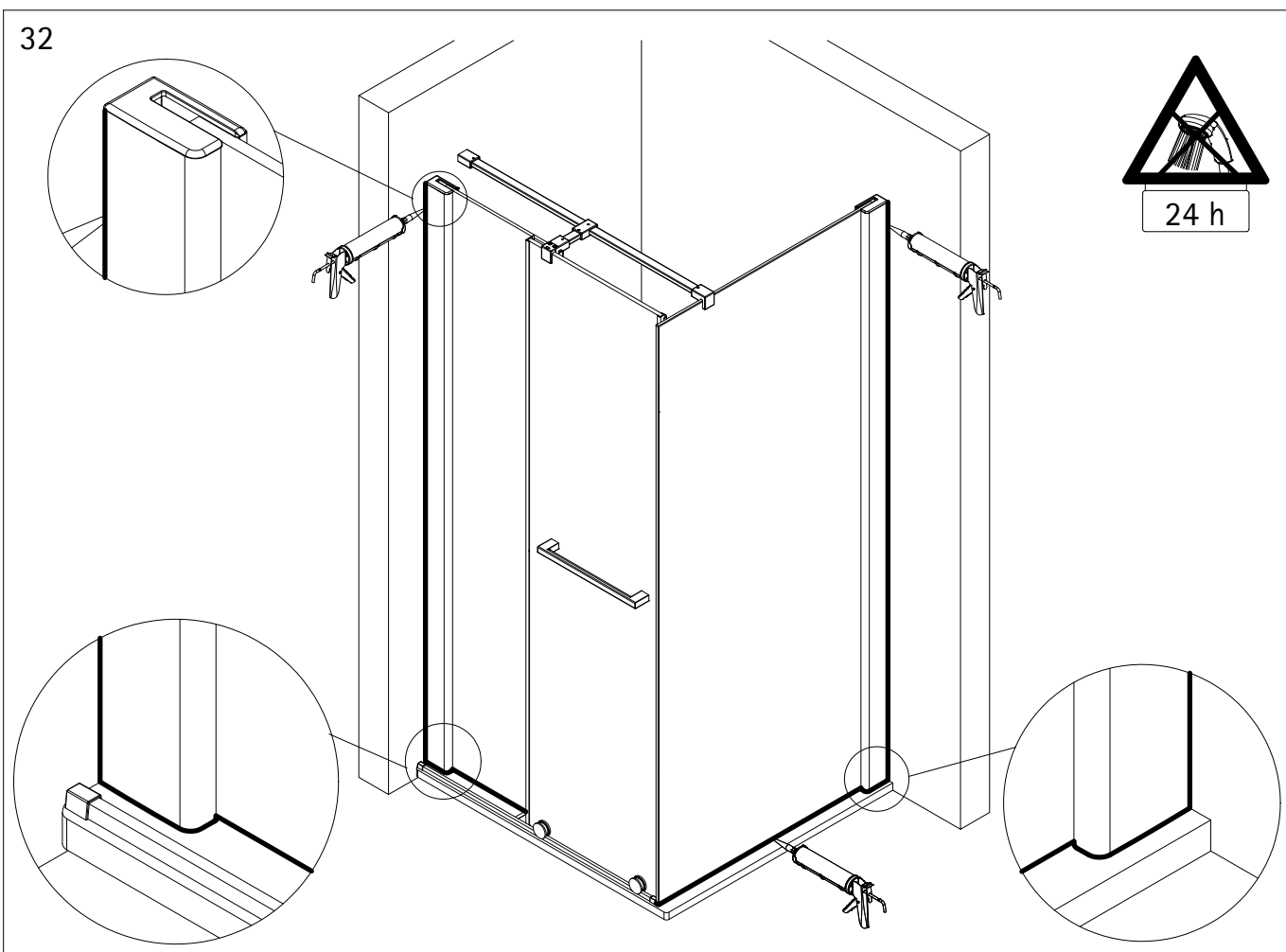

Hinweis Demontage/ Note for disassembly/ Remarque sur le démontage/ Informatie demontage

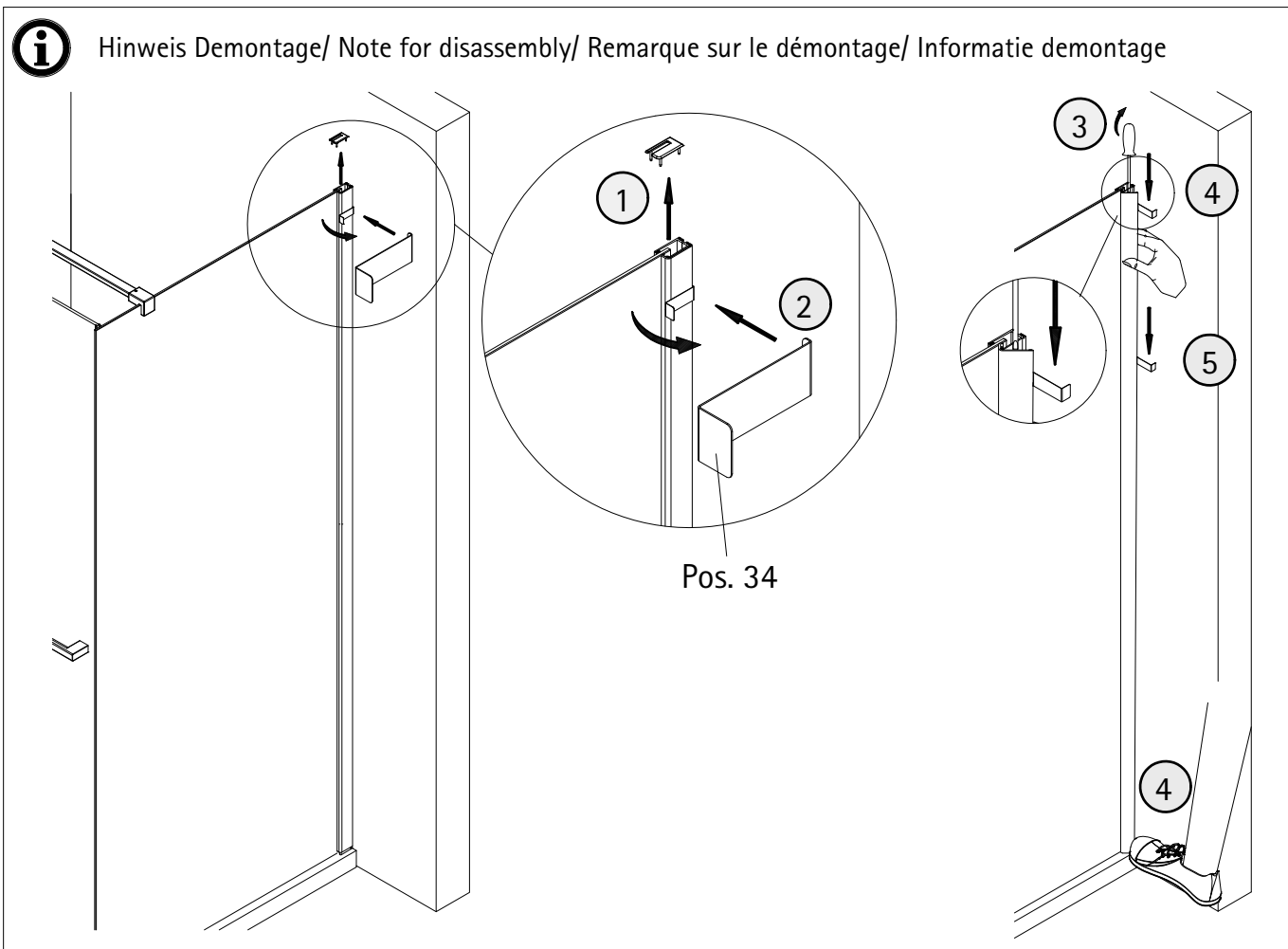

Notizen, notes, notities

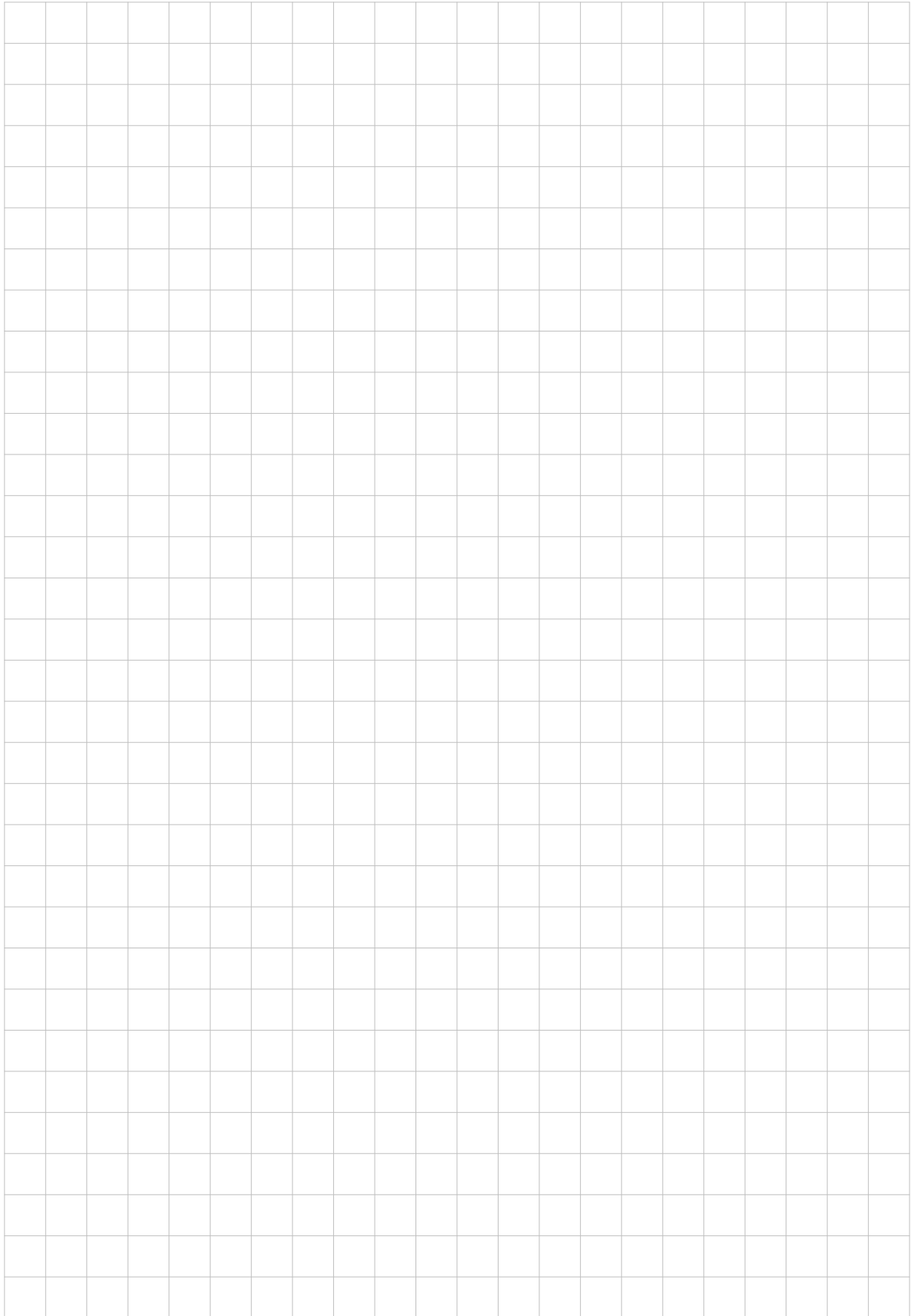

1947-8

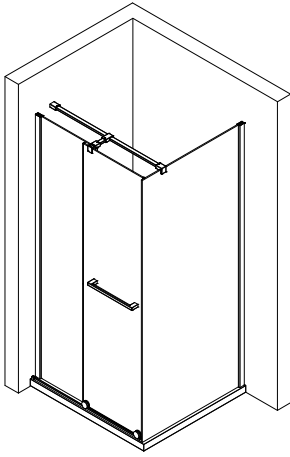

Prüfnummer / Inspection number / Numéro de contrôle / Testnummer



Ersatzteilbestellung / spare parts order
commande de pièces détachées / Bestelling van onderdelen:
Fax 02962 / 972-4260



Technische Hilfe / technical help / l'aide technique / technologische ondersteuning
Telefon 02962 / 9724-0



E-Mail:
ersatzteile@duschservice.de



Duschservice
Zum Hohlen Morgen 22
59939 Olsberg
Deutschland / Germany / Allemagne / Duitsland



0000714980000000000000000000